

LNT65-SPA-MX

2W SAUNA/ STEAM RATED FLEXIBLE LED NEON SERIES

Project _____
Location _____
Quote/ Ref # _____

The **LNT65-SPA-MX** is a high performance flexible LED fixture designed for use in a sauna/steam environment. Designed to resist high temperatures with its adaptive constant current control built-in feature. It is a flexible strip light that can bend around contours or tight curves horizontally or vertically without being damaged.



SPECIFICATIONS

INPUT VOLTAGE	24V DC Constant Voltage
POWER CONSUMPTION	2W per Ft.
LUMEN OUTPUT	90 Lm/ Ft.
CRI	88+
DIMMING/ CONTROL	0-10V
MAXIMUM RUN LENGTH	32 Ft.
CUTTABLE	Every 55.6mm (2.19 in)
STORAGE TEMPERATURE	-40°F (-40°C) to 176°F (80°C)
OPERATING TEMPERATURE	-4°F (-20°C) to 194°F (90°C)
BEAM ANGLE	160°
LED CHIP	NICHIA
HUMIDITY	0-95% Non Condensing
IP RATING	IP67
CERTIFICATIONS	UL Listed
LUMEN MAINTENANCE	50,000 Hrs.

FEATURES

- Sauna/ Steam rated for use in higher temperatures
- High color consistency and smooth illumination
- Multiple CCT options available
- Continuous run length up to 32 Ft.
- Bottom, Side and End Feed options
- UL Listed (US and Canada)



MODEL	SURFACE	TEMP A	TEMP B	VOLT	LENGTH	POWER FEED	FEED LENGTH
LNT65-SPA-MX	HB Horizontal Bend	22K 2200K	27K 2700K	24 24V DC	Please refer to page 4-5 for exact lengths with corresponding ordering codes.	BF Bottom Feed	HW3 3 Ft. Power Feed
		25K 2500K	30K 3000K			SFL Side Feed Left	HW10 10 Ft. Power Feed
	27K 2700K	35K 3500K	SFR Side Feed Right			HW15 15 Ft. Power Feed	
	30K 3000K	42K 4200K	EF End Feed			HW30 30 Ft. Power Feed	
	35K 3500K	50K 5000K				HW50 50 Ft. Power Feed	
	42K 4200K	60K 6000K					
	50K 5000K						
	60K 6000K						

LNT65-SPA-MX

2W SAUNA/ STEAM RATED FLEXIBLE LED NEON SERIES

DIMENSIONS

LNT65-HB (HORIZONTAL BEND)

LNT65-VB (VERTICAL BEND)

POWER FEED CHOKER

All CORE Lighting IP67/IP68 Neons include a choker that sits roughly 5" from the end of the Neon.

**Warranty is void if removed.*

COMPATIBLE ACCESSORIES

SELF LOCKING ALUMINUM PROFILE

LNT65-AC2
2" PROFILE

LNT65-AC39
39" PROFILE

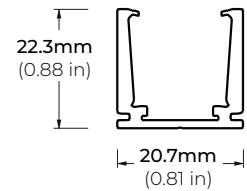

PLASTIC PROFILE

LNT65-PC39
39" PROFILE

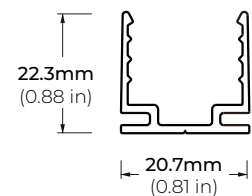

RECESSED PROFILE

LNT65-RS39
39" PROFILE

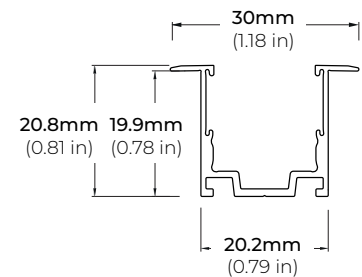
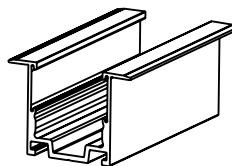

FLEXIBLE PROFILE

LNT65-SPX39-WH
39" PROFILE (WHITE)

LNT65-SPX39-BK
39" PROFILE (BLACK)

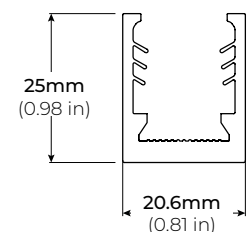
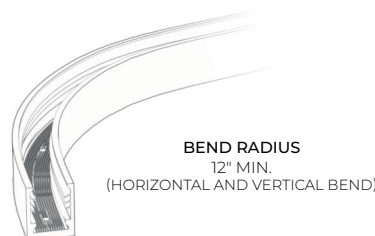

LNT65-SPA-MX

2W SAUNA/ STEAM RATED FLEXIBLE LED NEON SERIES

COMPATIBLE ACCESSORIES

RACEWAY PROFILE

LNT65-ARC39-SI
39" PROFILE (SILVER)

LNT65-ARC39-WH
39" PROFILE (WHITE)

LNT65-ARC39-BK
39" PROFILE (BLACK)

LNT65-ARC-EC
END CAPS

* Set of 2 (1 with Hole and 1 without Hole)

* Sold Separately

LNT65-ARC-JB
JOINER BRACKET

* Sold Separately

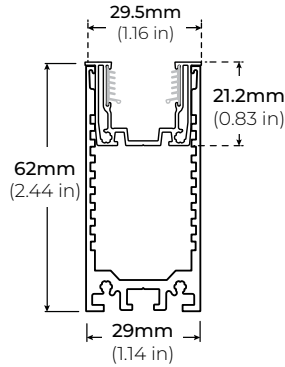

LNT65-ARC39

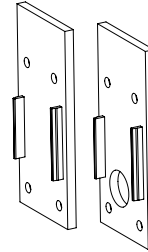

LNT65-ARC-EC

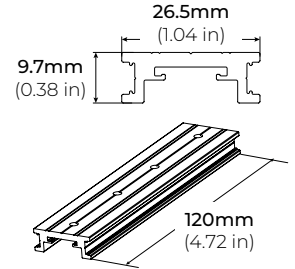

LNT65-ARC-JB

LNT65-BKT-ADJ
ADJUSTABLE BRACKET

* Only compatible with LNT65-AC2 and LNT65-AC39

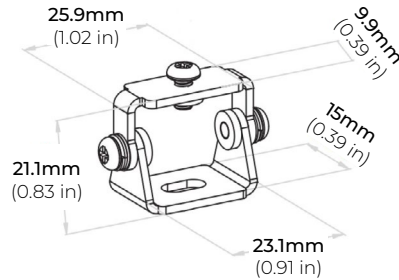

LNT65-SPA-MX

2W SAUNA/ STEAM RATED FLEXIBLE LED NEON SERIES

POWER FEED

BF
BOTTOM FEED

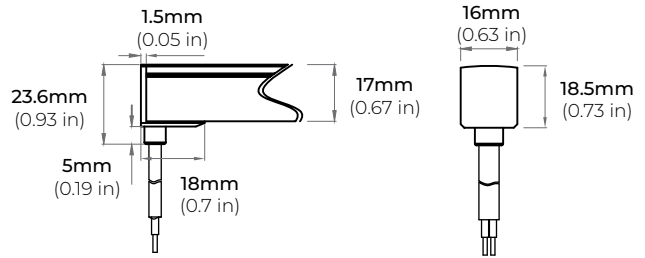

SFL
SIDE FEED LEFT

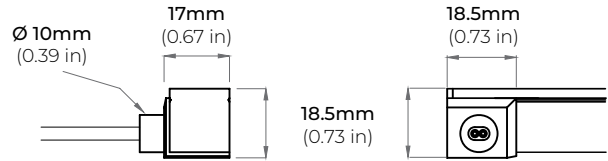
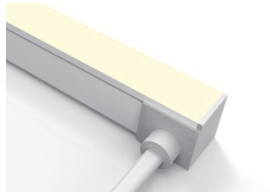

SFR
SIDE FEED RIGHT

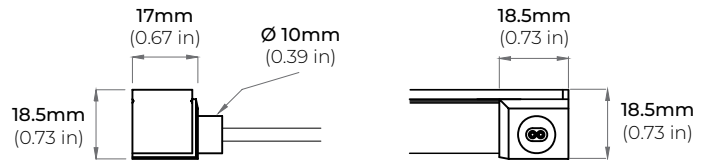

EF
END FEED

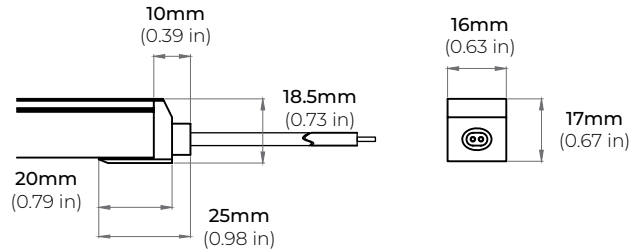

LNT65-EC
END CAP

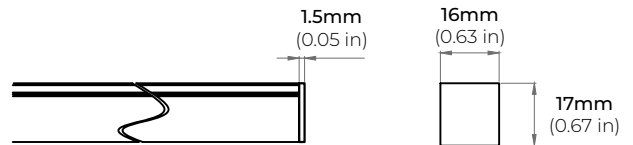
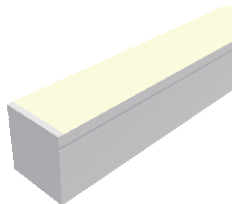

LNT65-SPA-MX

2W SAUNA/ STEAM RATED FLEXIBLE LED NEON SERIES

CUTTING LENGTH CODES

LNT65-SPA-MX is cuttable every 2.19" (5.56CM). Please refer to the chart below to determine actual lengths once LED is cut versus actual lengths required or specified.

Total Length Calculation = Order Code Length + End Feed option Length

Example: 65.9" Total Length = Order Code 30 (65.7") + (0.20") Side Feed

* Optional lead wire lengths available: 3Ft., 10Ft., 16Ft., 32Ft., 50Ft.

POWER FEED OPTION	
END FEED	1.1"
BOTTOM FEED	0.20"
SIDE FEED	0.20"

CUTTING LENGTH INCREMENT TABLE

CODE	LENGTH (CM)	LENGTH (IN)
3	16.8	6.57
4	22.4	8.76
5	28	10.95
6	33.6	13.14
7	39.2	15.33
8	44.8	17.52
9	50.4	19.71
10	56	21.9
11	61.6	24.09
12	67.2	26.28
13	72.8	28.47
14	78.4	30.66
15	84	32.85
16	89.6	35.04
17	95.2	37.23
18	100.8	39.42
19	106.4	41.61
20	112	43.8
21	117.6	45.99
22	123.2	48.18
23	128.8	50.37
24	134.4	52.56
25	140	54.75
26	145.6	56.94
27	151.2	59.13
28	156.8	61.32
29	162.4	63.51
30	168	65.7
31	173.6	67.89
32	179.2	70.08
33	184.8	72.27
34	190.4	74.46
35	196	76.65
36	201.6	78.84
37	207.2	81.03
38	212.8	83.22
39	218.4	85.41
40	224	87.6
41	229.6	89.79
42	235.2	91.98

CODE	LENGTH (CM)	LENGTH (IN)
43	240.8	94.17
44	246.4	96.36
45	252	98.55
46	257.6	100.74
47	263.2	102.93
48	268.8	105.12
49	274.4	107.31
50	280	109.5
51	285.6	111.69
52	291.2	113.88
53	296.8	116.07
54	302.4	118.26
55	308	120.45
56	313.6	122.64
57	319.2	124.83
58	324.8	127.02
59	330.4	129.21
60	336	131.4
61	341.6	133.59
62	347.2	135.78
63	352.8	137.97
64	358.4	140.16
65	364	142.35
66	369.6	144.54
67	375.2	146.73
68	380.8	148.92
69	386.4	151.11
70	392	153.3
71	397.6	155.49
72	403.2	157.68
73	408.8	159.87
74	414.4	162.06
75	420	164.25
76	425.6	166.44
77	431.2	168.63
78	436.8	170.82
79	442.4	173.01
80	448	175.2
81	453.6	177.39
82	459.2	179.58

CODE	LENGTH (CM)	LENGTH (IN)
83	464.8	181.77
84	470.4	183.96
85	476	186.15
86	481.6	188.34
87	487.2	190.53
88	492.8	192.72
89	498.4	194.91
90	504	197.1
91	509.6	199.29
92	515.2	201.48
93	520.8	203.67
94	526.4	205.86
95	532	208.05
96	537.6	210.24
97	543.2	212.43
98	548.8	214.62
99	554.4	216.81
100	560	219
101	565.6	221.19
102	571.2	223.38
103	576.8	225.57
104	582.4	227.76
105	588	229.95
106	593.6	232.14
107	599.2	234.33
108	604.8	236.52
109	610.4	238.71
110	616	240.9
111	621.6	243.09
112	627.2	245.28
113	632.8	247.47
114	638.4	249.66
115	644	251.85
116	649.6	254.04
117	655.2	256.23
118	660.8	258.42
119	666.4	260.61
120	672	262.8
121	677.6	264.99
122	683.2	267.18

LNT65-SPA-MX

2W SAUNA/ STEAM RATED FLEXIBLE LED NEON SERIES

CUTTING LENGTH CODES (CONT.)

LNT65-SPA-MX Series is cuttable every 2.19" (5.56CM). Please refer to the chart below to determine actual lengths once LED is cut versus actual lengths required or specified.

Total Length Calculation = Order Code Length + End Feed option Length

Example: 65.9" Total Length = Order Code 30 (65.7") + (0.20") Side Feed

* Optional lead wire lengths available: 3Ft., 10Ft., 16Ft., 32Ft., 50Ft.

POWER FEED OPTION	
END FEED	1.1"
BOTTOM FEED	0.20"
SIDE FEED	0.20"

CUTTING LENGTH INCREMENT TABLE

CODE	LENGTH (CM)	LENGTH (IN)
123	688.8	269.37
124	694.4	271.56
125	700	273.75
126	705.6	275.94
127	711.2	278.13
128	716.8	280.32
129	722.4	282.51
130	728	284.7
131	733.6	286.89
132	739.2	289.08
133	744.8	291.27
134	750.4	293.46
135	756	295.65
136	761.6	297.84
137	767.2	300.03
138	772.8	302.22
139	778.4	304.41
140	784	306.6
141	789.6	308.79
142	795.2	310.98
143	800.8	313.17
144	806.4	315.36
145	812	317.55
146	817.6	319.74
147	823.2	321.93
148	828.8	324.12
149	834.4	326.31
150	840	328.5
151	845.6	330.69
152	851.2	332.88
153	856.8	335.07
154	862.4	337.26
155	868	339.45
156	873.6	341.64
157	879.2	343.83
158	884.8	346.02
159	890.4	348.21
160	896	350.4
161	901.6	352.59
162	907.2	354.78

CODE	LENGTH (CM)	LENGTH (IN)
163	912.8	356.97
164	918.4	359.16
165	924	361.35
166	929.6	363.54
167	935.2	365.73
168	940.8	367.92
169	946.4	370.11
170	952	372.3
171	957.6	374.49
172	963.2	376.68
173	968.8	378.87
174	974.4	381.06
175	980	383.25
176	985.6	385.44
177	991.2	387.63
178	996.8	389.82
179	1002.4	392.01
180	1008	394.2

LNT65-SPA-MX

2W SAUNA/ STEAM RATED FLEXIBLE LED NEON SERIES

DMX CONTROLLERS

RGB CT600
MULTI-FUNCTION RGBW WALL CONTROLLER

INPUT VOLTAGE 5V DC, 1A
OUTPUT SIGNAL RF 2.4GHZ + DMX512
CONTROL 4 ZONES
COLOR OPTIONS Black/ White
WORKING TEMP -20°C ~ 40°C
DIMENSIONS LxWxH (5.19"x7.08"x1.38")

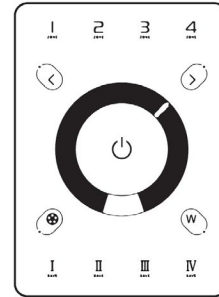

RGB-SCW4
WiFi DMX WALL CONTROLLER

INPUT VOLTAGE 5 - 10V DC, 06A
OUTPUT SIGNAL DMX512 (x2)
PROGRAMMABILITY PC/ MAC
COLOR OPTIONS Black/ White
CONNECTIONS USB/ 8dry contact ports/ Open drain output (for relay)
MEMORY Built-In Flash
WORKING TEMP -10°C ~ 45°C
DIMENSIONS LxWxH (5.75"x4.17"x0.43")

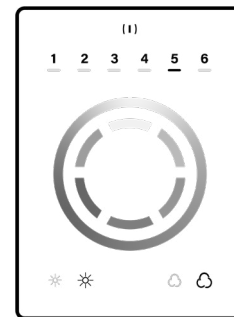

RGB-SDE3
WiFi DMX WALL CONTROLLER

INPUT VOLTAGE 6V DC, 0.6A
OUTPUT SIGNAL DMX512 (x2)
PROGRAMMABILITY PC/ MAC/ Tablet/ Smartphone
COLOR OPTIONS Black/ White
CONNECTIONS USB/ Ethernet/ RS232/ CLock/ 8dry contact ports/ 5V output relay
MEMORY MicroSD Card
WORKING TEMP -20°C ~ 40°C
DIMENSIONS LxWxH (5.75"x4.17"x0.43")

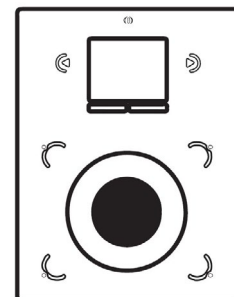

LNT65-SPA-MX

2W SAUNA/ STEAM RATED FLEXIBLE LED NEON SERIES

DMX DECODERS

RGB-DMX-4C-RJ45 4-CHANNEL DMX DECODER

INPUT VOLTAGE 12V-24V DC
OUTPUT CURRENT 8A X 4CH
OUTPUT WATTAGE 4 x (96W ~ 288W)
OUTPUT CHANNELS 4
DIMENSIONS LxWxH (6.5"x2.38"x1.27")

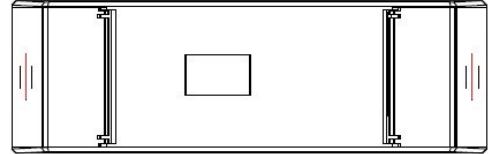

RGB-DMX-5C-XLR 5-CHANNEL DMX DECODER

INPUT VOLTAGE 12V-24V DC
OUTPUT CURRENT 8A X 5CH
OUTPUT WATTAGE 5 x (96W ~ 192W)
OUTPUT CHANNELS 5
DIMENSIONS LxWxH (6.45"x2.87"x1.5")

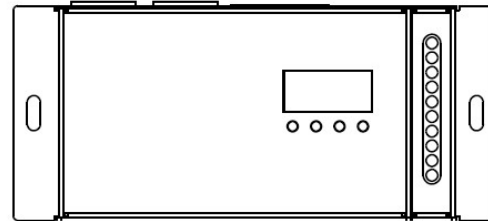

LNT65-SPA-MX

2W SAUNA/ STEAM RATED FLEXIBLE LED NEON SERIES

COMPATIBLE 0-10V DIMMING MODULE

PSDE-TW2-010-CT
0-10V CONTROL

INPUT VOLTAGE	8-48V DC
INPUT CURRENT	5.1A MAX (per channel)
INPUT CONTROL	2
OUTPUT CURRENT	5A
MAX OUTPUT POWER	240W
DIMENSIONS	LxWxH (3.86" X 1.73" X 0.57")



BASIC CONTROLLERS

RGB-CT820
BLUETOOTH TOUCH PANEL WALL CONTROLLER

INPUT VOLTAGE	12-24V DC
ZONES	4
CONTROL MODE	Color Tuning
WIRELESS PROTOCOL	Bluetooth 5.0 SIG Mesh
WORKING TEMP	-20°C ~ 55°C
DIMENSIONS	LxWxH (4.7"x3"x1.2")

** Paired with RGB-CT800-RC (Sold Separately)*



RGB-CT800-RC
BLUETOOTH CONSTANT VOLTAGE LED RECEIVER

INPUT VOLTAGE	12V 24V
OUTPUT CURRENT	4Ax5CH / 5Ax4CH (20A Max)
POWER CAPACITY	240W (12V) 480W (24V)
PROGRAMMABILITY	iOS and Android
WORKING TEMP	-20°C ~ 55°C
DIMENSIONS	LxWxH (6.9 x 1.7 x 1.2")

** Paired with RGB-CT820 (Sold Separately)*



NON-DIMMING DRIVERS (COMPATABLE WITH ALL SYSTEMS)

PSHK SERIES
NON-DIMMING CONSTANT VOLTAGE WITH JUNCTION BOX

PSHK-30W-24V	CLASS 2	6.5" X 3.6" X 1.02"
PSHK-60W-24V	CLASS 2	7.4" X 3.62" X 1.02"
PSHK-96W-24V	CLASS 2	8.66" X 3.66" X 1.61"
PSHK-150W-24V		10.24" X 4.06" X 1.81"
PSHK-200W-24V		10.24" X 4.06" X 1.81"
PSHK-288W-24V	CLASS 2	11.85" X 4.25" X 1.82"
PSHK-300W-24V		10.24" X 4.25" X 1.81"

