

# LSP-20 RGB

## 2.2W INDOOR COLOR CHANGING LED STRIP

Project \_\_\_\_\_  
Location \_\_\_\_\_  
Quote/ Ref # \_\_\_\_\_

**LSP-20 RGB** is a color-changing flexible LED strip that provides a full spectrum of color options using red, green and blue LED technology. The countless color mixing possibilities make RGB LEDs a diverse choice for even the most critical in lighting solutions and applications. It can be easily installed onto most surfaces with its double sided mounting tapes.

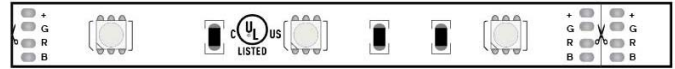

### SPECIFICATIONS

INPUT VOLTAGE	12V   24V DC
POWER CONSUMPTION	2.2W
LUMEN OUTPUT	82 Lm/ Ft.
COLOR TEMPERATURE	RGB
DIMMING	Through RGB Controller
MAXIMUM RUN LENGTH	20FT (12V)   30FT (24V)
CUTTABLE	Every 4" (12V)   every 8" (24V)
OPERATING TEMPERATURE	5°C (41°F) to 70°C (158°F)
AMBIENT TEMPERATURE	-20°C (4°F) to 40°C (108°F)
BEAM ANGLE	120°
IP RATING	IP54 Indoor rated
CERTIFICATIONS	UL Listed
LUMEN MAINTENANCE	50,000 Hrs.

### FEATURES

- Available in 12V and 24V
- 2.2W
- Full range RGB
- Continuous run up to 20 FT (12V)
- Continuous run up to 30 FT (24V)
- California TITLE 24 JA8 compliant
- Field cuttable
- Suitable for accent or ambient lighting
- Superior Color Rendering Index

\*Approved for closet / storage space installation per NEC 410.16(A)(3) and 410.16(C)(5)



MODEL	COLOR TEMP	LENGTH	VOLTAGE	PROFILE
LSP20	RGB RGB	16 16.4 Ft.	12 12V	See Page 2 for compatible profiles.
		100 100 Ft.	24 24V DC	
		1XX Per Ft.		

\*1 = Custom length per FT.  
(12V cuttable every 4")  
(24V cuttable every 8")

\* Custom color finishes require powder coating. Allow 7 days leads time.

# LSP-20 RGB

## 2.2W INDOOR COLOR CHANGING LED STRIP

### DIMENSIONS

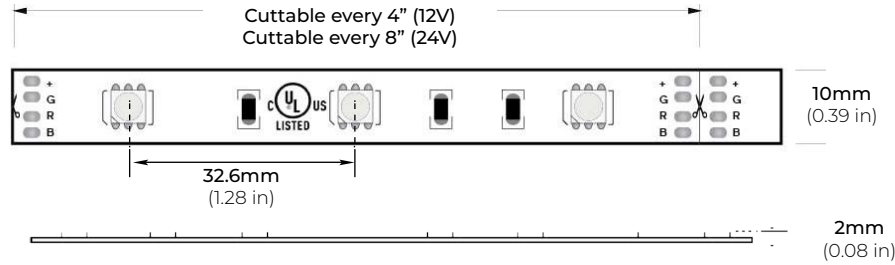

### COMPATIBLE ALUMINUM PROFILES

#### SURFACE PROFILES

##### ALU-SF

LENGTHS 39" | 78" | 84" | 98"  
LENS Clear, Frosted  
FINISH Black | Silver

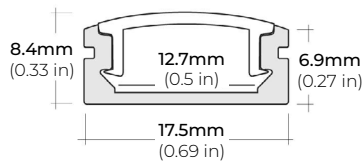

##### ALU-CN (CORNER)

LENGTHS 39" | 78" | 84" | 96"  
LENS Clear, Frosted  
FINISH Black | Silver

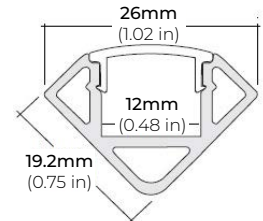

##### ALU-DS100

LENGTHS 39" | 78" | 84"  
LENS Clear, Frosted  
FINISH Silver

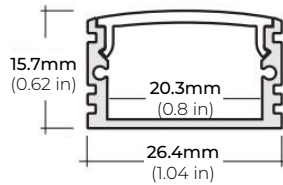

##### ALP-20

LENGTHS 49.25" | 84" | 98.5"  
LENS Frosted  
FINISH White | Black | Silver

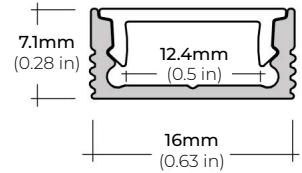

##### ALP-60

LENGTHS 49.25" | 84" | 98.5"  
LENS Frosted  
FINISH White | Black | Silver

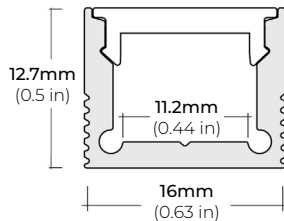

##### ALP-70

LENGTHS 49.25" | 84" | 98.5"  
LENS Frosted  
FINISH White | Black | Silver

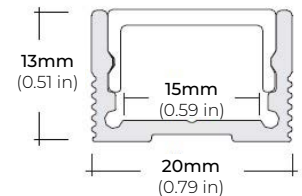

##### ALP-75C (CORNER)

LENGTHS 49" | 84" | 98"  
LENS Frosted  
FINISH Black | Silver

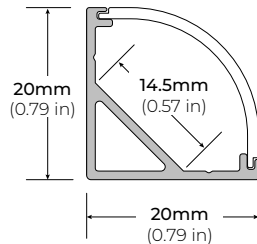

##### ALP-130

LENGTHS 49" | 84" | 98"  
LENS Frosted  
FINISH Silver

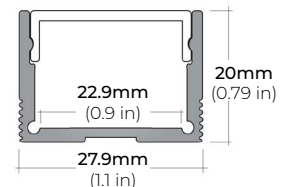

#### RECESSED PROFILES

##### ALP-60R

LENGTHS 49.25" | 84" | 98.5"  
LENS Frosted  
FINISH White | Black | Silver

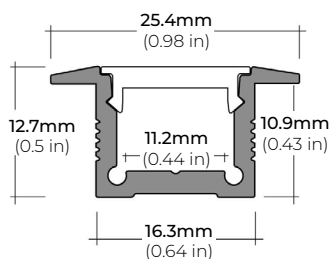

##### ALP-102R

LENGTHS 49" | 98"  
LENS Frosted, Black, Asymmetric, Double Asymmetric  
FINISH Silver

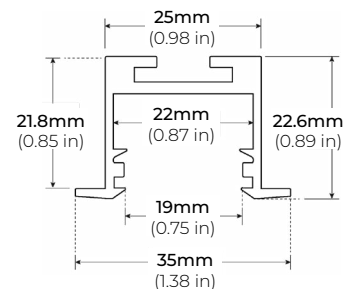

\* For more compatible profiles, visit [corelightingusa.com](http://corelightingusa.com)

# LSP-20 RGB

## 2.2W INDOOR COLOR CHANGING LED STRIP

### DMX CONTROLLERS

**RGB CT600**  
MULTI-FUNCTION RGBW WALL CONTROLLER

**INPUT VOLTAGE** 5V DC, 1A  
**OUTPUT SIGNAL** RF 2.4GHZ + DMX512  
**CONTROL** 4 ZONES  
**COLOR OPTIONS** Black/ White  
**WORKING TEMP** -20°C ~ 40°C  
**DIMENSIONS** LxWxH (5.19"x7.08"x1.38")

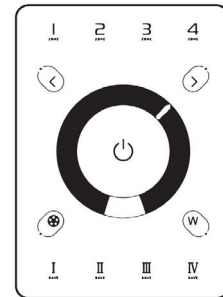

**RGB-SCW4**  
WiFi DMX WALL CONTROLLER

**INPUT VOLTAGE** 5 - 10V DC, 06A  
**OUTPUT SIGNAL** DMX512 (x2)  
**PROGRAMMABILITY** PC/ MAC  
**COLOR OPTIONS** Black/ White  
**CONNECTIONS** USB/ 8dry contact ports/ Open drain output (for relay)  
**MEMORY** Built-In Flash  
**WORKING TEMP** -10°C ~ 45°C  
**DIMENSIONS** LxWxH (5.75"x4.17"x0.43")

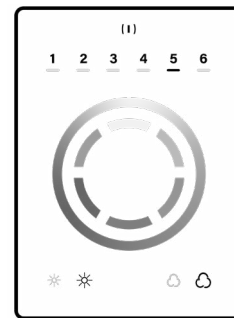

**RGB-SDE3**  
WiFi DMX WALL CONTROLLER

**INPUT VOLTAGE** 6V DC, 0.6A  
**OUTPUT SIGNAL** DMX512 (x2)  
**PROGRAMMABILITY** PC/ MAC/ Tablet/ Smartphone  
**COLOR OPTIONS** Black/ White  
**CONNECTION** USB/ Ethernet/ RS232/ CLock/ 8dry contact ports/ 5V output relay  
**MEMORY** MicroSD Card  
**WORKING TEMP** -20°C ~ 40°C  
**DIMENSIONS** LxWxH (5.75"x4.17"x0.43")

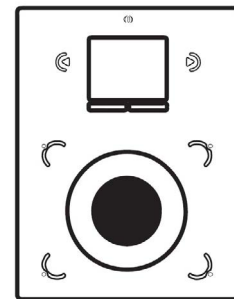

# LSP-20 RGB

## 2.2W INDOOR COLOR CHANGING LED STRIP

### DMX DECODERS

---

#### RGB-DMX-4C-RJ45 4-CHANNEL DMX DECODER

INPUT VOLTAGE 12V-24V DC  
OUTPUT CURRENT 8A X 4CH  
OUTPUT WATTAGE 4 x (96W ~ 288W)  
OUTPUT CHANNELS 4  
DIMENSIONS LxWxH (6.5"x2.38"x1.27")

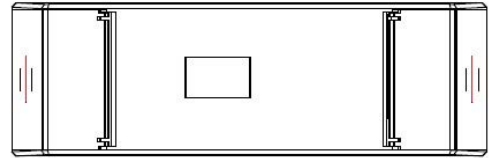

---

#### RGB-DMX-5C-XLR 5-CHANNEL DMX DECODER

INPUT VOLTAGE 12V-24V DC  
OUTPUT CURRENT 8A X 5CH  
OUTPUT WATTAGE 5 x (96W ~ 192W)  
OUTPUT CHANNELS 5  
DIMENSIONS LxWxH (6.45"x2.87"x1.5")

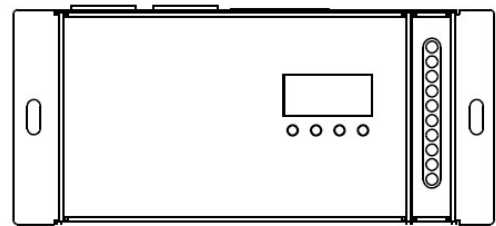

# LSP-20 RGB

## 2.2W INDOOR COLOR CHANGING LED STRIP

### NON-DMX CONTROLLERS

#### RGB-CT550

RGBW WIRELESS RECEIVER / CONTROLLER SYSTEM

REMOTE DISTANCE	100 Ft. (Line of Sight)
FREQUENCY	2.4 GHz
DIMENSIONS	LxWxH (6.38"x1.65"x0.59")
WEIGHT	0.44lbs.

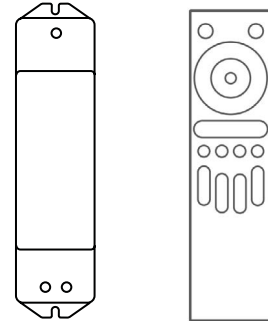

\* RGB-CT500-RX  
(Sold Separately)

#### RGB-CT550-RX

RGBW WIRELESS RECEIVER / CONTROLLER SYSTEM

INPUT VOLTAGE	DC5V ~ DC24V
POWER CAPACITY	100W (5V)   240W (12V)   480W (24V)
OUTPUT CURRENT	5A per Channel (20A Total)
WORKING TEMP	-30°C~55°C (-22°F~131°F)
DIMENSIONS	LxWxH (6.89"x1.73"x1.18")

\* RGB-CT500-RX (Sold Separately)

#### RGB-CT700

MASTER RGBW WIFI CONTROLLER

INPUT VOLTAGE	12-24V DC
OUTPUT TYPE	Constant Voltage
POWER CAPACITY	288W (12V)   384W (24V)
OUTPUT CURRENT	5A per Channel (20A Total)
WORKING TEMP	-4°F (-20°C) ~ 122°F (50°C)
DIMENSIONS	LxWxH (7 x1.8 x 0.8")

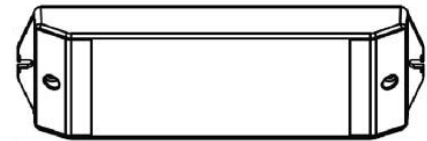

\* Paired with RGB-CT705ZR (Sold Separately)

#### RGB-CT705ZR

SLAVE RGBW WIFI CONTROLLER

INPUT VOLTAGE	12-24V DC
OUTPUT TYPE	Constant Voltage
POWER CAPACITY	288W (12V)   384W (24V)
OUTPUT CURRENT	5A per Channel (20A Total)
WORKING TEMP	-4°F (-20°C) ~ 122°F (50°C)
DIMENSIONS	LxWxH (7 x0,63 x 0.71")

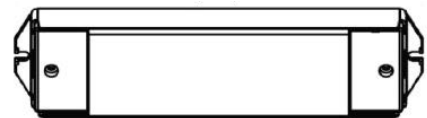

\* Paired with RGB-CT700 (Sold Separately)

# LSP-20 RGB

## 2.2W INDOOR COLOR CHANGING LED STRIP

### NON-DMX CONTROLLERS (CONTINUED)

**RGB-CT840**  
BLUETOOTH TOUCH PANEL WALL CONTROLLER

**INPUT VOLTAGE** 12-24V DC  
**ZONES** 4  
**CONTROL MODE** RGB | RGBW  
**WIRELESS PROTOCOL** Bluetooth 5.0 SIG Mesh  
**WORKING TEMP** -20°C ~ 55°C  
**DIMENSIONS** LxWxH (4.7"x3"x1.2")

*\* Paired with RGB-CT800-RC (Sold Separately)*



**RGB-CT800-RC**  
BLUETOOTH CONSTANT VOLTAGE LED RECEIVER

**INPUT VOLTAGE** 12V | 24V  
**OUTPUT CURRENT** 4Ax5CH / 5Ax4CH (20A Max)  
**POWER CAPACITY** 240W (12V) | 480W (24V)  
**PROGRAMMABILITY** iOS and Android  
**WORKING TEMP** -20°C ~ 55°C  
**DIMENSIONS** LxWxH (6.9 x1.7 x 1.2")

*\* Paired with RGB-CT840 (Sold Separately)*



### NON-DIMMING DRIVERS (COMPATIBLE WITH ALL SYSTEMS)

**PSHK SERIES**  
NON-DIMMING CONSTANT VOLTAGE WITH JUNCTION BOX

<b>PSHK-30W-24V</b>	<b>CLASS 2</b>	6.5" X 3.6" X 1.02"
<b>PSHK-60W-24V</b>	<b>CLASS 2</b>	7.4" X 3.62" X 1.02"
<b>PSHK-96W-24V</b>	<b>CLASS 2</b>	8.66" X 3.66" X 1.61"
<b>PSHK-150W-24V</b>		10.24" X 4.06" X 1.81"
<b>PSHK-200W-24V</b>		10.24" X 4.06" X 1.81"
<b>PSHK-288W-24V</b>	<b>CLASS 2</b>	11.85" X 4.25" X 1.82"
<b>PSHK-300W-24V</b>		10.24" X 4.25" X 1.81"

