

LSMW-15

1.5W OUTDOOR FLEXIBLE LED STRIP

Project _____
Location _____
Quote/ Ref # _____

LSMW-15 is an outdoor flexible LED strip that delivers 120 lumens at 1.5 Watts per ft. This LED strip is rated to last 50,000 hours making it an excellent replacement for halogen lighting. This product is suitable for use in most residential and commercial applications, it is easy to install. Offered in different CCT options with superior CRI.

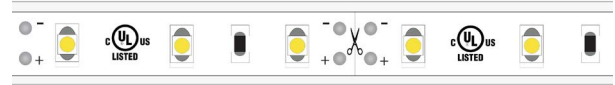

SPECIFICATIONS

| | |
|-----------------------|---|
| INPUT VOLTAGE | 12V 24V DC |
| POWER CONSUMPTION | 1.5W per Ft. |
| NO. OF LEDS | 18 LEDs per Ft. |
| LUMEN OUTPUT | 115 Lm/Ft. (3000K) |
| CRI | 95+ |
| COLOR TEMPERATURE | 22K / 24K / 27K / 30K / 35K / 40K / 50K 60K / RD / BL / GR / PK / PR / AM / OR |
| DIMMING | MLV, ELV, 0-10 and TRIAC |
| MAXIMUM RUN LENGTH | 16.4 Ft. (12V) 24 Ft. (24V) |
| CUTTABLE | Every 1.98" (50.22mm) (12V) Every 3.91" in. (99.27mm) (24V) |
| BINNING | 1.5 Step Macadam Elipse |
| OPERATING TEMPERATURE | -40°F (-40°C) ~ +140°F (+60°C) |
| BEAM ANGLE | 120° |
| IP RATING | IP65 wet location (outdoor) |
| CERTIFICATIONS | UL Listed, TITLE 24 JA8 |
| LUMEN MAINTENANCE | 50,000 Hrs. |

LUMENS

| CCT | LM/ FT | CRI | R9 | R13 |
|-------|--------|-----|----|-----|
| 2700K | 114 | 95 | 86 | 98 |
| 3000K | 115 | 95 | 86 | 98 |
| 3500K | 117 | 93 | 83 | 96 |
| 4000K | 119 | 95 | 98 | 99 |
| 5000K | 123 | 94 | 96 | 99 |

*Approved for closet / storage space installation per NEC 410.16(A)(3) and 410.16(C)(5)



| MODEL | COLOR TEMP | | LENGTH | VOLTAGE | PROFILE |
|--------|---------------------|---------------------|--|---------------------|--|
| LSMW15 | 22K 2200K | RD Red | 16 16 Ft. | 12 12V | See Page 2 for compatible profiles. |
| | 24K 2400K | BL Blue | 25 25 Ft. | 24 24V DC | |
| | 27K 2700K | GR Green | 32 32 Ft. | | |
| | 30K 3000K | PK Pink | 1XX per Ft. | | |
| | 35K 3500K | PR Purple | | | |
| | 40K 4000K | AM Amber | | | |
| | 50K 5000K | OR Orange | | | |
| | 60K 6000K | | | | |
| | | | *1 = Custom length per FT. (12V Strip cuttable every 1.98") (24V Strip cuttable every 3.91") | | * Custom color finishes require powder coating. Allow 7 days leads time. |

LSMW-15

1.5W OUTDOOR FLEXIBLE LED STRIP

DIMENSIONS

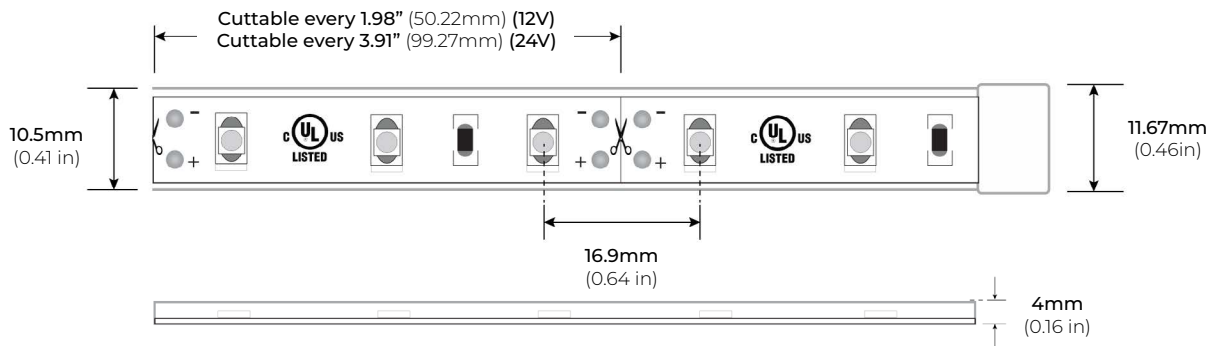

COMPATIBLE ALUMINUM PROFILES

SURFACE PROFILES

ALU-SF

LENGTHS 39" | 78" | 84" | 98"
LENS Clear, Frosted
FINISH Black | Silver

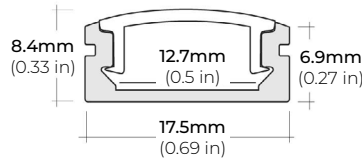

ALU-CN (CORNER)

LENGTHS 39" | 78" | 84" | 96"
LENS Clear, Frosted
FINISH Black | Silver

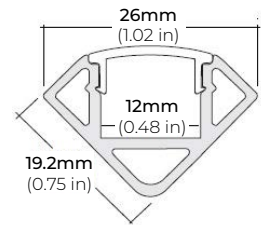

ALU-DS100

LENGTHS 39" | 78" | 84"
LENS Clear, Frosted
FINISH Silver

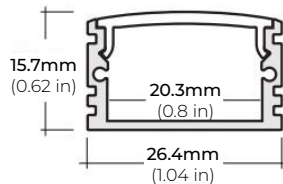

ALP-20

LENGTHS 49" | 84" | 98"
LENS Frosted
FINISH White | Black | Silver

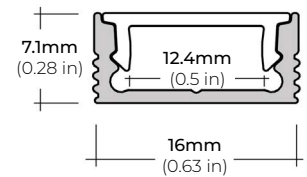

ALP-75C (CORNER)

LENGTHS 49" | 84" | 98"
LENS Frosted
FINISH Black | Silver

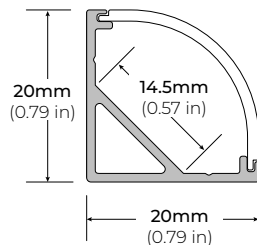

ALP-80

LENGTHS 49.25" | 98.5"
LENS Frosted
FINISH Silver

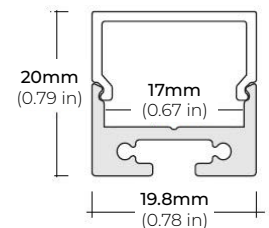

* For more compatible profiles, visit corelightingusa.com

RECESSED PROFILES

ALP-20R

LENGTHS 49" | 98"
LENS Frosted
FINISH White | Black | Silver

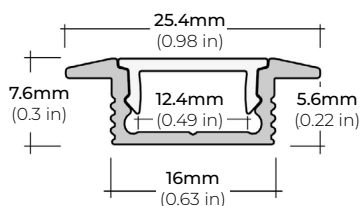

ALP-60R

LENGTHS 49" | 84" | 98"
LENS Frosted
FINISH White | Black | Silver

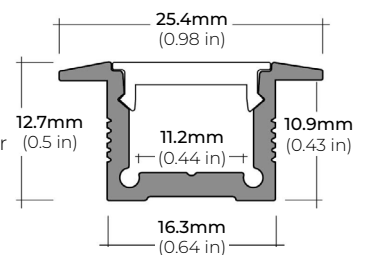

* For more compatible profiles, visit corelightingusa.com

LSMW-15

1.5W OUTDOOR FLEXIBLE LED STRIP

COMPATIBLE TRANSFORMERS

PSDL SERIES TRIAC DIMMABLE

| | | |
|---------------|---------|------------------------|
| PSDL-30W-12V | CLASS 2 | 6.5" X 3.63" X 1.58" |
| PSDL-60W-12V | CLASS 2 | 7.4" X 3.63" X 1.58" |
| PSDL-100W-12V | CLASS 2 | 8.67" X 3.67 X 1.62" |
| PSDL-150W-12V | | 10.25" X 4.06" X 1.82" |
| PSDL-200W-12V | | 10.25" X 4.06" X 1.82" |
| PSDL-300W-12V | | 10.25" X 4.06" X 1.82" |

| | | |
|---------------|---------|------------------------|
| PSDL-30W-24V | CLASS 2 | 6.5" X 3.63" X 1.58" |
| PSDL-60W-24V | CLASS 2 | 7.4" X 3.63" X 1.58" |
| PSDL-96W-24V | CLASS 2 | 8.67" X 3.67 X 1.62" |
| PSDL-150W-24V | | 10.25" X 4.06" X 1.82" |
| PSDL-192W-24V | CLASS 2 | 11" X 4" X 1.82" |
| PSDL-200W-24V | | 10.25" X 4.06" X 1.82" |
| PSDL-288W-24V | CLASS 2 | 11.85" X 4.25" X 1.82" |
| PSDL-300W-24V | | 10.25" X 4.06" X 1.82" |

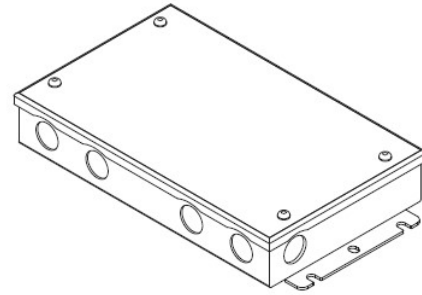

PSDH SERIES HIGH PERFORMANCE MAGNETIC LOW VOLTAGE (MLV)

| | | |
|---------------|---------|------------------------|
| PSDH-48W-24V | CLASS 2 | 11.25" X 3.38" X 3.38" |
| PSDH-96W-24V | CLASS 2 | 11.25" X 3.38" X 3.37" |
| PSDH-288W-24V | CLASS 2 | 14.25" X 8.43" X 4.43" |

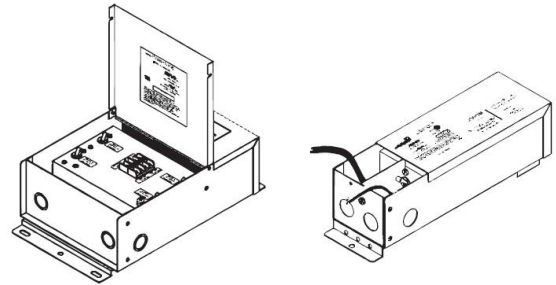

PSRX SERIES 4-IN-1 DIMMING DRIVER W/ JUNCTION BOX

| | | |
|-------------------|---------|------------------------|
| PSRX-30W-12V-UNV | CLASS 2 | 6.5" X 3.72" X 1.57" |
| PSRX-60W-12V-UNV | CLASS 2 | 7.4" X 3.72" X 1.57" |
| PSRX-150W-12V-UNV | | 10.24" X 4.13" X 1.77" |

| | | |
|-------------------|---------|------------------------|
| PSRX-30W-24V-UNV | CLASS 2 | 6.5" X 3.7" X 1.57" |
| PSRX-60W-24V-UNV | CLASS 2 | 7.4" X 3.72" X 1.57" |
| PSRX-96W-24V-UNV | CLASS 2 | 8.66" X 3.72" X 1.57" |
| PSRX-150W-24V-UNV | | 10.24" X 4.13" X 1.77" |
| PSRX-200W-24V-UNV | | 10.24" X 4.13" X 1.77" |
| PSRX-300W-24V-UNV | | 10.94" X 4.33" X 1.77" |

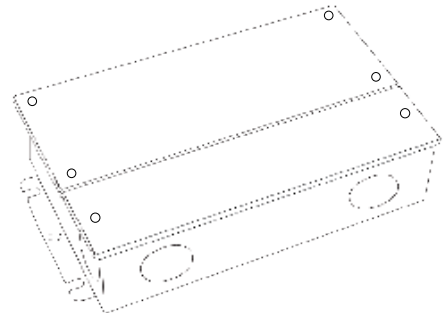

LSMW-15

1.5W OUTDOOR FLEXIBLE LED STRIP

COMPATIBLE TRANSFORMERS

PSVT SERIES

0-10V DIMMING WITH JUNCTION BOX

| | | |
|-----------------------|---------|------------------------|
| PSVT-60W-24V-UNV-010 | CLASS 2 | 7.4" X 3.72" X 1.57" |
| PSVT-96W-24V-UNV-010 | CLASS 2 | 8.66" X 3.72" X 1.57" |
| PSVT-200W-24V-UNV-010 | | 10.24" X 4.13" X 1.77" |
| PSVT-288W-24V-UNV-010 | CLASS 2 | 11.85" X 4.25" X 1.81" |
| PSVT-300W-24V-UNV-010 | | 10.94" X 4.33" X 1.77" |

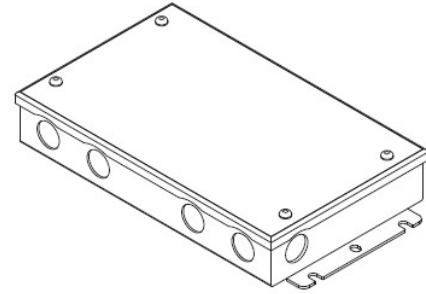

PSDE SERIES

0-10V DIMMING W/ JUNCTION BOX

| | | |
|---------------------|---------|----------------------|
| PSDE-60W-24V-010-JB | CLASS 2 | 12.1" X 2.36" X 1.4" |
| PSDE-96W-24V-010-JB | CLASS 2 | 12.1" X 2.36" X 1.4" |

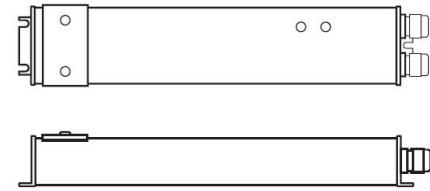

LUTRON 1%

3-WIRE DIMMING

| | | |
|------------------|---------|--------------------|
| L3DA4U1UKL-CV240 | CLASS 2 | 4.89" X 4" X 2.62" |
|------------------|---------|--------------------|

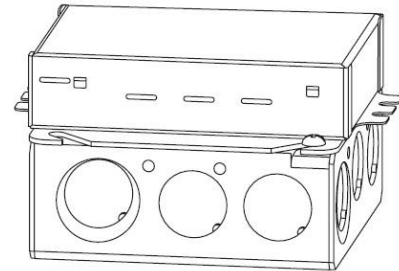

LUTRON 1%

| | | |
|------------------|---------|---------------------|
| PSDE-96W-24V-ECO | CLASS 2 | 10.5" X 3.0" X 2.0" |
|------------------|---------|---------------------|

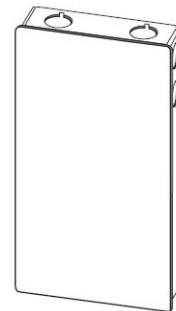

LSMW-15

1.5W OUTDOOR FLEXIBLE LED STRIP

COMPATIBLE NON-DIMMING DRIVERS

PSHK SERIES

NON-DIMMING CONSTANT VOLTAGE WITH JUNCTION BOX

| | | |
|---------------|---------|------------------------|
| PSHK-30W-24V | CLASS 2 | 6.5" X 3.6" X 1.02" |
| PSHK-60W-24V | CLASS 2 | 7.4" X 3.62" X 1.02" |
| PSHK-96W-24V | CLASS 2 | 8.66" X 3.66" X 1.61" |
| PSHK-150W-24V | | 10.24" X 4.06" X 1.81" |
| PSHK-200W-24V | | 10.24" X 4.06" X 1.81" |
| PSHK-288W-24V | CLASS 2 | 11.85" X 4.25" X 1.82" |
| PSHK-300W-24V | | 10.94" X 4.25" X 1.81" |

