

LSM-40WD-10MM

4W INDOOR AUTO WARM-DIM FLEXIBLE LED STRIP

Project _____
Location _____
Quote/ Ref # _____

LSM-40WD is a new warm-dim LED strip with smart chip technology. Using a standard wall box dimmer, LED light source automatically shifts color temperature from 3000K down to 1800K as it is being dimmed. LSM-40WD provides Warm-Dim technology at a fraction of the price without the need for any special lighting control system.

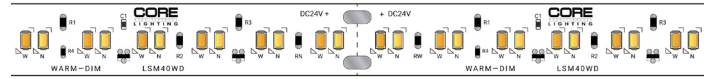

SPECIFICATIONS

| | |
|-----------------------|-------------------------------|
| INPUT VOLTAGE | 24V DC |
| POWER CONSUMPTION | 4W per Ft. |
| NO. OF LEDS | 64 LEDs per Ft. |
| LUMEN OUTPUT | 253 Lm/Ft. |
| CRI | 95+ |
| DIMMING/ CONTROL | MLV, ELV, 0-10 and TRIAC |
| MAXIMUM RUN LENGTH | 12 Ft. |
| FIELD CUTTABLE | Every 2.4 in (61.1mm) |
| BINNING | 1.5 Step Macadam Elipse |
| OPERATING TEMPERATURE | -40°F (-40°C) ~ 140°F (60°C) |
| BEAM ANGLE | 120° |
| IP RATING | IP20 (Indoor) |
| CERTIFICATIONS | UL Listed, TITLE 24 JA8, RoHS |
| LUMEN MAINTENANCE | 50,000 Hrs. |

*Approved for closet / storage space installation per NEC 410.16(A)(3) and 410.16(C)(5)



| MODEL | COLOR TEMP | LENGTH | VOLTAGE | PROFILE |
|---------|-------------------------------|---|---------------------|--|
| LSM40WD | 18/27K 1800K/ 2700K | 16 16.4 Ft. | 24 24V DC | <i>See Page 3 for compatible profiles.</i> |
| | 18/30K 1800K/ 3000K | 50 50 Ft. | | |
| | 1XX per Ft. | | | |
| | | *1 = Custom length per FT. (Cuttable every 2.4") | | * Custom color finishes require powder coating. Allow 7 days leads time. |

LSM-40WD-10MM

4W INDOOR AUTO WARM-DIM FLEXIBLE LED STRIP

DIMENSIONS

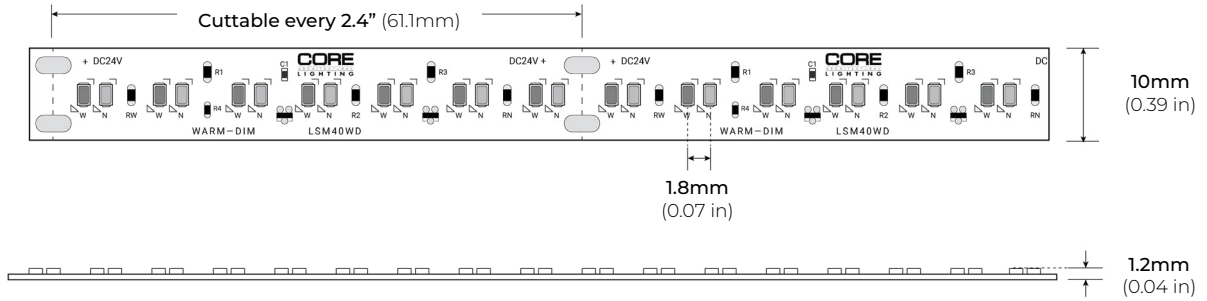

COMPATIBLE CONNECTORS

HP PRO CONNECTORS

QUICK CONNECT SNAP-ON

- LSA-HW8-HPX10 8" HARDWIRE CONNECTOR
- LSA-HW24-HPX10 24" HARDWIRE CONNECTOR
- LSA-HW60-HPX10 60" HARDWIRE CONNECTOR
- LSA-HW120-HPX10 120" HARDWIRE CONNECTOR

- LSA-EX3-HPX10 3" LINK
- LSA-EX8-HPX10 8" LINK
- LSA-EX24-HPX10 24" LINK

- LSA-DC24-HP-X10 24" DC CONNECTOR

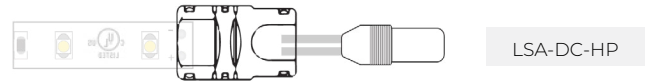
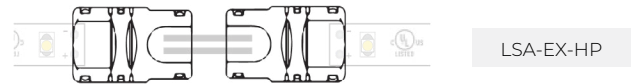
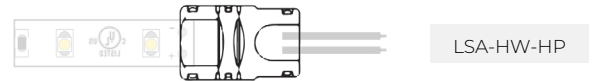

MINI CRIMP CONNECTORS

QUICK CONNECT

- LSA-HWPC-24-X10 24" HARDWIRE CONNECTOR

- LSA-EXPC-3-X10 3" LINK

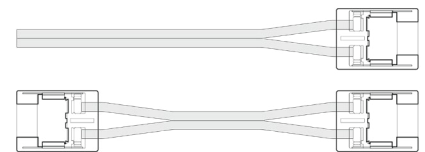

LSM-40WD-10MM

4W INDOOR AUTO WARM-DIM FLEXIBLE LED STRIP

COMPATIBLE ALUMINUM PROFILES

SURFACE PROFILES

ALP-20

LENGTHS 49" | 84" | 98"
LENS Frosted
FINISH White | Black | Silver

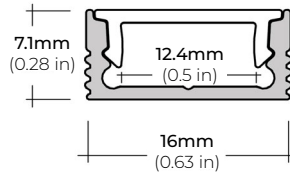

ALP-50C-V2 (CORNER)

LENGTHS 48" | 84" | 98"
LENS Frosted
FINISH White | Black | Silver

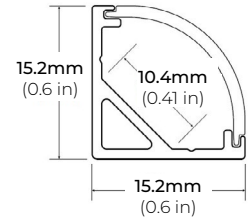

ALP-60

LENGTHS 49" | 84" | 98"
LENS Frosted
FINISH White | Black | Silver

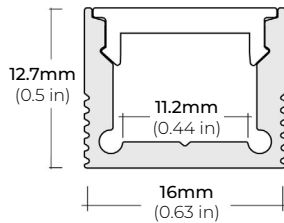

* For more compatible profiles, visit corelightingusa.com

LSM-40WD-10MM

4W INDOOR AUTO WARM-DIM FLEXIBLE LED STRIP

COMPATIBLE TRANSFORMERS

PSDL SERIES TRIAC DIMMABLE

| | | |
|---------------|---------|------------------------|
| PSDL-30W-24V | CLASS 2 | 6.5" X 3.63" X 1.03" |
| PSDL-60W-24V | CLASS 2 | 7.4" X 3.63" X 1.03" |
| PSDL-96W-24V | CLASS 2 | 8.67" X 3.67 X 1.62" |
| PSDL-150W-24V | | 8.67" X 3.67" X 1.62" |
| PSDL-192W-24V | CLASS 2 | 10.25" X 4.06" X 1.82" |
| PSDL-200W-24V | | 10.25" X 4.06" X 1.82" |
| PSDL-288W-24V | CLASS 2 | 10.25" X 4.06" X 1.82" |
| PSDL-300W-24V | | 10.25" X 4.06" X 1.82" |

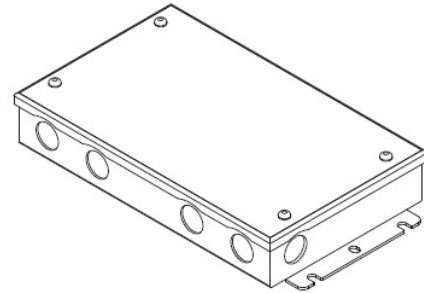

PSDH SERIES HIGH PERFORMANCE MAGNETIC LOW VOLTAGE (MLV)

| | | |
|---------------|---------|------------------------|
| PSDH-48W-24V | CLASS 2 | 11.25" X 3.37" X 3.25" |
| PSDH-96W-24V | CLASS 2 | 11.25" X 3.37" X 3.25" |
| PSDH-288W-24V | CLASS 2 | 14.25" X 8.43" X 4.43" |

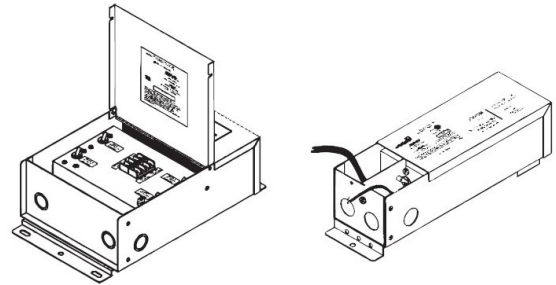

PSRX SERIES 4-IN-1 DIMMING DRIVER

| | | |
|---------------|---------|------------------------|
| PSRX-30W-24V | CLASS 2 | 6.5" X 3.72" X 1.57" |
| PSRX-60W-24V | CLASS 2 | 7.4" X 3.72" X 1.57" |
| PSRX-96W-24V | CLASS 2 | 8.66" X 3.72" X 1.57" |
| PSRX-150W-24V | | 10.24" X 4.13" X 1.77" |
| PSRX-192W-24V | CLASS 2 | 11" X 4" X 1.82" |
| PSRX-200W-24V | | 10.24" X 4.13" X 1.77" |
| PSRX-288W-24V | CLASS 2 | 11.85" X 4.25" X 1.82" |
| PSRX-300W-24V | | 10.94" X 4.33" X 1.77" |

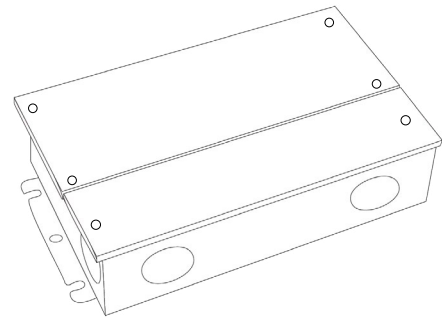

PSVT SERIES 0-10V DIMMING DRIVER

| | | |
|---------------|---------|------------------------|
| PSVT-60W-24V | CLASS 2 | 7.4" X 3.72" X 1.57" |
| PSVT-96W-24V | CLASS 2 | 8.66" X 3.72" X 1.57" |
| PSVT-200W-24V | | 10.24" X 4.13" X 1.77" |
| PSVT-288W-24V | CLASS 2 | 11.85" X 4.25" X 1.81" |
| PSVT-300W-24V | | 10.94" X 4.33" X 1.77" |

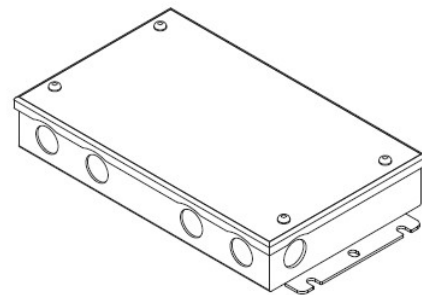

LSM-40WD-10MM

4W INDOOR AUTO WARM-DIM FLEXIBLE LED STRIP

COMPATIBLE TRANSFORMERS

PSDE SERIES
0-10V DIMMING W/ JUNCTION BOX

| | | |
|---------------------|---------|----------------------|
| PSDE-60W-24V-010-JB | CLASS 2 | 12.1" X 2.36" X 1.4" |
| PSDE-96W-24V-010-JB | CLASS 2 | 12.1" X 2.36" X 1.4" |

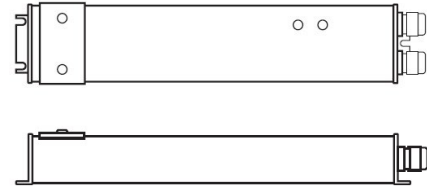

LUTRON 1%
3-WIRE DIMMING

| | | |
|------------------|---------|--------------------|
| L3DA4U1UKL-CV240 | CLASS 2 | 4.89" X 4" X 2.62" |
|------------------|---------|--------------------|

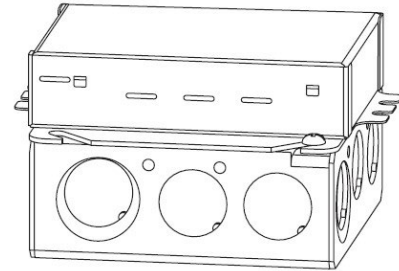

LUTRON 1%

| | | |
|------------------|---------|---------------------|
| PSDE-96W-24V-ECO | CLASS 2 | 10.5" X 3.0" X 2.0" |
|------------------|---------|---------------------|

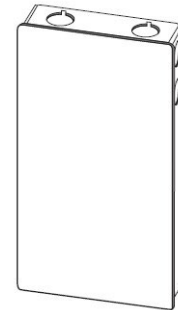

COMPATIBLE NON-DIMMING DRIVERS

PSHK SERIES
NON-DIMMING CONSTANT VOLTAGE WITH JUNCTION BOX

| | | |
|---------------|---------|------------------------|
| PSHK-30W-24V | CLASS 2 | 6.5" X 3.6" X 1.02" |
| PSHK-60W-24V | CLASS 2 | 7.4" X 3.62" X 1.02" |
| PSHK-96W-24V | CLASS 2 | 8.66" X 3.66" X 1.61" |
| PSHK-150W-24V | | 10.24" X 4.06" X 1.81" |
| PSHK-200W-24V | | 10.24" X 4.06" X 1.81" |
| PSHK-288W-24V | CLASS 2 | 11.85" X 4.25" X 1.82" |
| PSHK-300W-24V | | 10.24" X 4.25" X 1.81" |

