

# LSM-40HF

## 4.0W INDOOR FLEXIBLE LED STRIP

Project \_\_\_\_\_

Location \_\_\_\_\_

Quote/ Ref # \_\_\_\_\_

**LSM-40HF** is a High-Flux indoor, dimmable flexible LED strip capable of delivering 100 Lumens per watt of light output per ft. Its high lumen output, excellent color rendering, and various color temperature options make it the perfect choice for almost any commercial or residential lighting application.



### SPECIFICATIONS

INPUT VOLTAGE	24V DC
POWER CONSUMPTION	4W/Ft.
NO. OF LEDS	40 LEDs per Ft.
LUMEN OUTPUT	468 Lm/Ft. (3000K)
CRI	95+
COLOR TEMPERATURE	27K / 30K / 35K / 40K / 50K
DIMMING	MLV, ELV, 0-10V and TRIAC
MAXIMUM RUN LENGTH	16 Ft.
CUTTABLE	Every 2.46 in (62.52mm)
BINNING	1.5 Step Macadam Elipse
OPERATING TEMPERATURE	-40°F (-40°C) ~ +140°F (+60°C)
BEAM ANGLE	120°
IP RATING	Dry location (Indoor)
CERTIFICATIONS	UL Listed, TITLE 24 JA8
LUMEN MAINTENANCE	50,000 Hrs.

### LUMENS

CCT	LM/ FT	CRI	R9	R13
2700K	468	97	88	99
3000K	468	97	96	98
3500K	497	96	98	96
4000K	507	94	85	97
5000K	532	88	67	92

\*Approved for closet / storage space installation per NEC 410.16(A)(3) and 410.16(C)(5)



MODEL	COLOR TEMP	LENGTH	VOLTAGE	PROFILE
LSM40HF	<b>27K</b> 2700K	<b>16</b> 16 Ft.	<b>24</b> 24V DC	<i>See Page 2 for compatible profiles.</i>
	<b>30K</b> 3000K	<b>100</b> 100 Ft.		
	<b>35K</b> 3500K	<b>1XX</b> per Ft.		
	<b>40K</b> 4000K			
	<b>50K</b> 5000K			

\*1 = Custom length per FT.  
(Cuttable every 2.46")

\* Custom color finishes require powder coating. Allow 7 days lead time.

# LSM-40HF

## 4.0W INDOOR FLEXIBLE LED STRIP

### DIMENSIONS

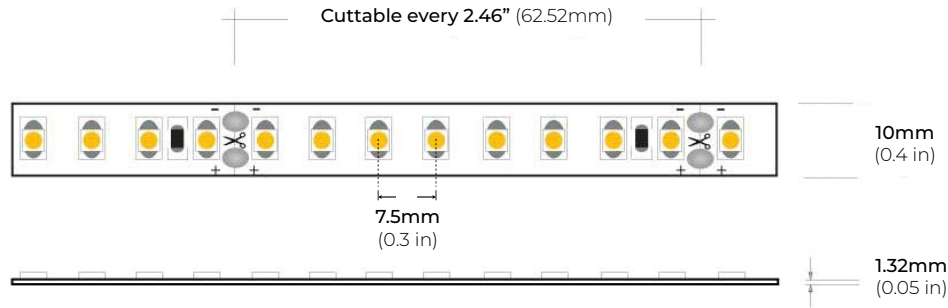

### COMPATIBLE ALUMINUM PROFILES

#### SURFACE PROFILES

##### ALU-SF

LENGTHS 39" | 78" | 84" | 98"  
LENS Clear, Frosted  
FINISH Black | Silver

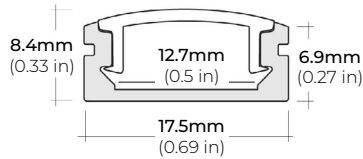

##### ALU-CN (CORNER)

LENGTHS 39" | 78" | 84" | 96"  
LENS Clear, Frosted  
FINISH Black | Silver

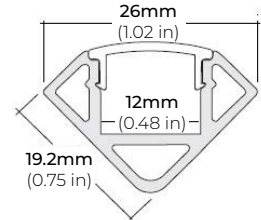

##### ALP-20

LENGTHS 49" | 84" | 98"  
LENS Frosted  
FINISH White | Black | Silver

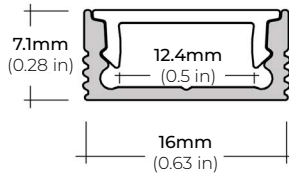

##### ALP-35

LENGTHS 49" | 98"  
LENS Frosted  
FINISH White | Black | Silver

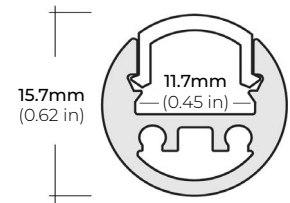

##### ALP-65

LENGTHS 48" | 96"  
LENS Clear  
FINISH Silver

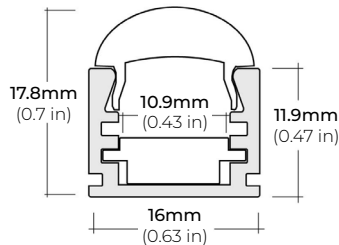

##### ALP-70

LENGTHS 49.25" | 84" | 98.5"  
LENS Frosted  
FINISH White | Black | Silver

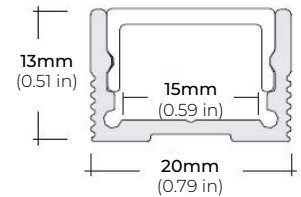

\* For more compatible profiles, visit [corelightingusa.com](http://corelightingusa.com)

#### RECESSED PROFILES

##### ALP-20R

LENGTHS 49" | 98"  
LENS Frosted  
FINISH White | Black | Silver

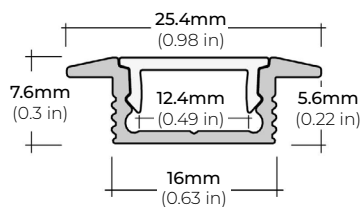

##### ALP-60R

LENGTHS 49" | 84" | 98"  
LENS Frosted  
FINISH White | Black | Silver

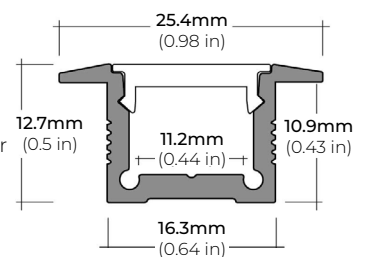

\* For more compatible profiles, visit [corelightingusa.com](http://corelightingusa.com)

# LSM-40HF

## 4.0W INDOOR FLEXIBLE LED STRIP

### COMPATIBLE TRANSFORMERS

#### PSDL SERIES TRIAC DIMMABLE

PSDL-30W-24V	CLASS 2	6.5" X 3.63" X 1.03"
PSDL-60W-24V	CLASS 2	7.4" X 3.63" X 1.03"
PSDL-96W-24V	CLASS 2	8.67" X 3.67 X 1.62"
PSDL-150W-24V		8.67" X 3.67" X 1.62"
PSDL-192W-24V	CLASS 2	10.25" X 4.06" X 1.82"
PSDL-200W-24V		10.25" X 4.06" X 1.82"
PSDL-288W-24V	CLASS 2	10.25" X 4.06" X 1.82"
PSDL-300W-24V		10.25" X 4.06" X 1.82"

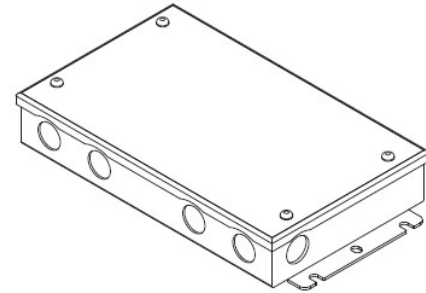

#### PSDH SERIES HIGH PERFORMANCE MAGNETIC LOW VOLTAGE (MLV)

PSDH-48W-24V	CLASS 2	11.25" X 3.37" X 3.25"
PSDH-96W-24V	CLASS 2	11.25" X 3.37" X 3.25"
PSDH-288W-24V	CLASS 2	14.25" X 8.43" X 4.43"

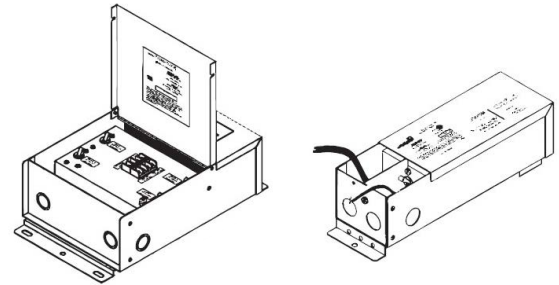

#### PSRX SERIES 4-IN-1 DIMMING DRIVER

PSRX-30W-24V	CLASS 2	6.5" X 3.72" X 1.57"
PSRX-60W-24V	CLASS 2	7.4" X 3.72" X 1.57"
PSRX-96W-24V	CLASS 2	8.66" X 3.72" X 1.57"
PSRX-150W-24V		10.24" X 4.13" X 1.77"
PSRX-192W-24V	CLASS 2	11" X 4" X 1.82"
PSRX-200W-24V		10.24" X 4.13" X 1.77"
PSRX-288W-24V	CLASS 2	11.85" X 4.25" X 1.82"
PSRX-300W-24V		10.94" X 4.33" X 1.77"

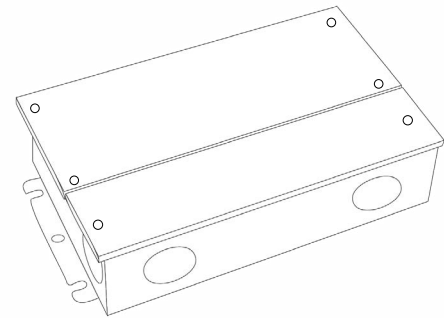

#### PSVT SERIES 0-10V DIMMING DRIVER

PSVT-60W-24V	CLASS 2	7.4" X 3.72" X 1.57"
PSVT-96W-24V	CLASS 2	8.66" X 3.72" X 1.57"
PSVT-200W-24V		10.24" X 4.13" X 1.77"
PSVT-288W-24V	CLASS 2	11.85" X 4.25" X 1.81"
PSVT-300W-24V		10.94" X 4.33" X 1.77"

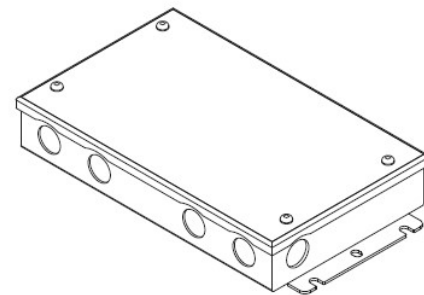

# LSM-40HF

## 4.0W INDOOR FLEXIBLE LED STRIP

### COMPATIBLE TRANSFORMERS

PSDE SERIES  
0-10V DIMMING W/ JUNCTION BOX

PSDE-60W-24V-010-JB      CLASS 2    12.1" X 2.36" X 1.4"  
PSDE-96W-24V-010-JB      CLASS 2    12.1" X 2.36" X 1.4"

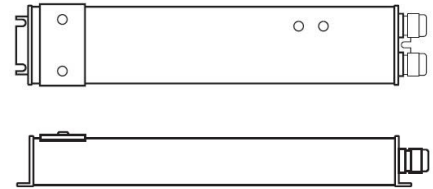

LUTRON 1%  
3-WIRE DIMMING

L3DA4U1UKL-CV240      CLASS 2    4.89" X 4" X 2.62"

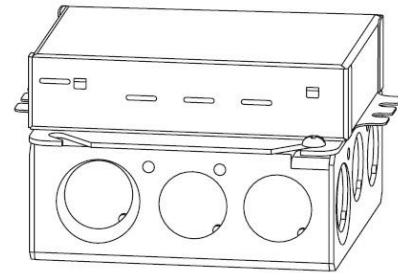

LUTRON 1%

PSDE-96W-24V-ECO      CLASS 2    10.5" X 3.0" X 2.0"

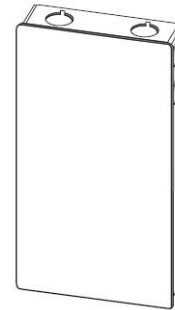

### COMPATIBLE NON-DIMMING DRIVERS

PSHK SERIES  
NON-DIMMING CONSTANT VOLTAGE WITH JUNCTION BOX

PSHK-30W-24V      CLASS 2    6.5" X 3.6" X 1.02"  
PSHK-60W-24V      CLASS 2    7.4" X 3.62" X 1.02"  
PSHK-96W-24V      CLASS 2    8.66" X 3.66" X 1.61"  
PSHK-150W-24V                 10.24" X 4.06" X 1.81"  
PSHK-200W-24V                 10.24" X 4.06" X 1.81"  
PSHK-288W-24V      CLASS 2    11.85" X 4.25" X 1.82"  
PSHK-300W-24V                 10.24" X 4.25" X 1.81"

