

# LSM-55 RGBW

## 5W INDOOR COLOR-CHANGING + WHITE LED STRIP

Project \_\_\_\_\_  
Location \_\_\_\_\_  
Quote/ Ref # \_\_\_\_\_

**LSM-55 RGBW** series is a flexible color-changing LED strip that provides the perfect lighting solution for spaces that require dynamic full color and white LED illumination. The warm white LED's combined with the full color spectrum of the RGB light array produces more powerful color options that's sure to please even the most discerning lighting designer.



### SPECIFICATIONS

INPUT VOLTAGE	24V DC
POWER CONSUMPTION	5W/Ft. <i>(4W/Ft. — RGB   1W/Ft. — White)</i>
LEDS/ FT.	128 LEDS per Ft.
LUMEN OUTPUT	238 Lm/ Ft. (30K)
CRI	95+
COLOR TEMPERATURE	RGB+27K / RGB+30K / RGB+40K
DIMMING	Through RGBW controller
MAXIMUM RUN LENGTH	16 Ft.
CUTTABLE	Every 2.46 in. (62.5mm) <i>(Field Cuttable)</i>
OPERATING TEMPERATURE	-40°F(-40°C)~140°F(60°C)
AMBIENT TEMPERATURE	-40°F(-40°C)~140°F(60°C)
BEAM ANGLE	120°
IP RATING	Indoor, dry location
CERTIFICATIONS	UL Listed, California TITLE 24 JA8
LUMEN MAINTENANCE	50,000 Hrs.

### LUMENS

CCT	RGB (LM/FT)	WHITE (LM/FT)	RGBW (LM/FT)
2700K	133	104	237
3000K	133	105	238
4000K	133	111	244

\*Approved for closet / storage space installation per NEC 410.16(A)(3) and 410.16(C)(5)



MODEL	COLOR TEMP	LENGTH	VOLTAGE	PROFILE
LSM55	<b>RGBW27K</b> RGB + 2700K	<b>10</b> 10Ft.	<b>24</b> 24V DC	See Page 3 for compatible profiles.
	<b>RGBW30K</b> RGB + 3000K	<b>20</b> 20Ft.		
	<b>RGBW40K</b> RGB + 4000K	<b>XX</b> Per Ft.		

# LSM-55 RGBW

## 5W INDOOR COLOR-CHANGING + WHITE LED STRIP

### DIMENSIONS

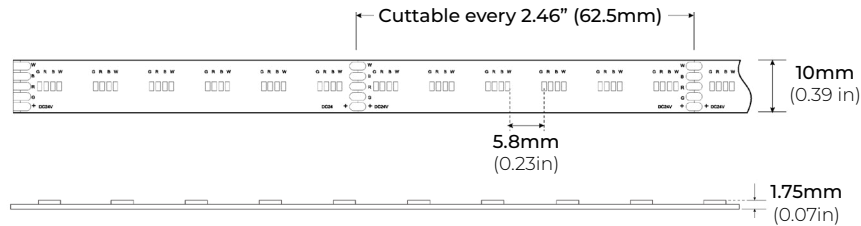

### COMPATIBLE ALUMINUM PROFILES

#### SURFACE PROFILES

##### ALU-SF

LENGTHS 39" | 78" | 84" | 98"  
LENS Clear, Frosted  
FINISH Black | Silver

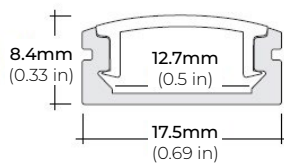

##### ALU-DS100

LENGTHS 39" | 78" | 84"  
LENS Clear, Frosted  
FINISH Silver

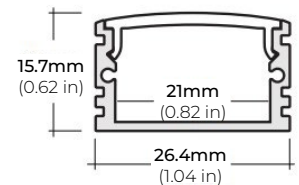

##### ALU-CN (CORNER)

LENGTHS 39" | 78" | 84" | 96"  
LENS Clear, Frosted  
FINISH Black | Silver

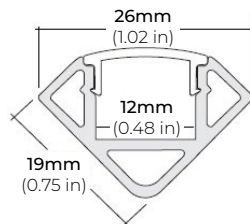

##### ALP-20

LENGTHS 49" | 84" | 98"  
LENS Frosted  
FINISH White | Black | Silver

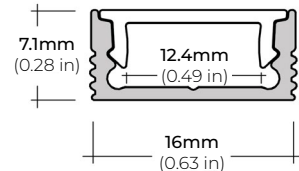

##### ALP-35

LENGTHS 49" | 98"  
LENS Clear, Frosted  
FINISH Silver

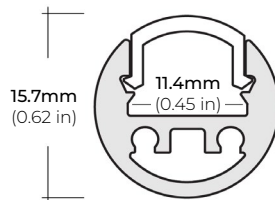

##### ALP-60

LENGTHS 49" | 84" | 98"  
LENS Frosted  
FINISH White | Black | Silver

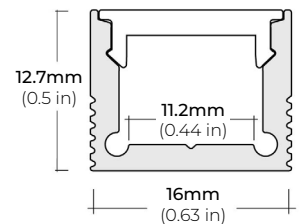

##### ALP-70

LENGTHS 49" | 84" | 98"  
LENS Frosted  
FINISH Black | Silver

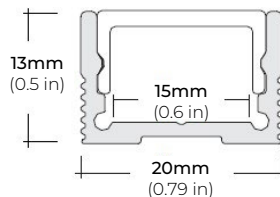

##### ALP-80

LENGTHS 49" | 98"  
LENS Frosted  
FINISH White | Black | Silver

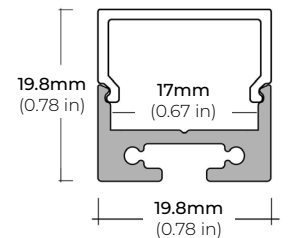

\* For more compatible profiles, visit [corelightingusa.com](http://corelightingusa.com)

#### RECESSED PROFILES

##### ALP-20R

LENGTHS 49" | 98"  
LENS Frosted  
FINISH White | Black | Silver

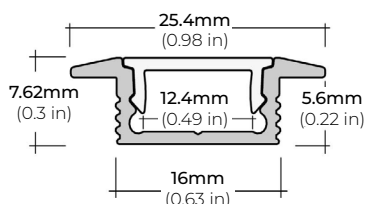

##### ALP-60R

LENGTHS 49" | 84" | 98"  
LENS Frosted  
FINISH White | Black | Silver

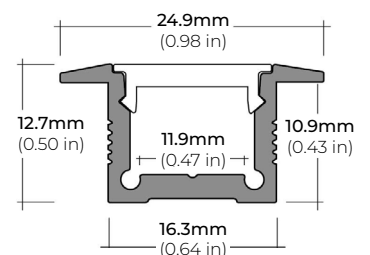

\* For more compatible profiles, visit [corelightingusa.com](http://corelightingusa.com)

# LSM-55 RGBW

## 5W INDOOR COLOR-CHANGING + WHITE LED STRIP

### DMX CONTROLLERS

#### RGB CT600 MULTI-FUNCTION RGBW WALL CONTROLLER

INPUT VOLTAGE	5V DC, 1A
OUTPUT SIGNAL	RF 2.4GHZ + DMX512
CONTROL	4 ZONES
COLOR OPTIONS	Black/ White
WORKING TEMP	-20°C ~ 40°C
DIMENSIONS	LxWxH (5.19"x7.08"x1.38")

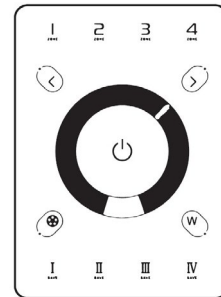

#### RGB-SCW4 WiFi DMX WALL CONTROLLER

INPUT VOLTAGE	5 - 10V DC, 06A
OUTPUT SIGNAL	DMX512 (x2)
PROGRAMMABILITY	PC/ MAC
COLOR OPTIONS	Black/ White
CONNECTIONS	USB/ 8dry contact ports/ Open drain output (for relay)
MEMORY	Built-In Flash
WORKING TEMP	-10°C ~ 45°C
DIMENSIONS	LxWxH (5.75"x4.17"x0.43")

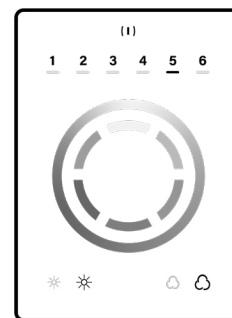

#### RGB-SDE3 WiFi DMX WALL CONTROLLER

INPUT VOLTAGE	6V DC, 0,6A
OUTPUT SIGNAL	DMX512 (x2)
PROGRAMMABILITY	PC/ MAC/ Tablet/ Smartphone
COLOR OPTIONS	Black/ White
CONNECTION	USB/ Ethernet/ RS232/ CLock/ 8dry contact ports/ 5V output relay
MEMORY	MicroSD Card
WORKING TEMP	-20°C ~ 40°C
DIMENSIONS	LxWxH (5.75"x4.17"x0.43")

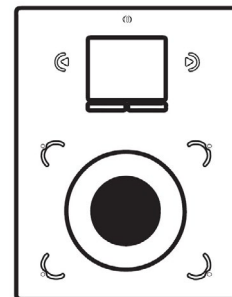

# LSM-55 RGBW

## 5W INDOOR COLOR-CHANGING + WHITE LED STRIP

### DMX DECODERS

---

#### RGB-DMX-4C-RJ45 4-CHANNEL DMX DECODER

INPUT VOLTAGE 12V-24V DC  
OUTPUT CURRENT 8A X 4CH  
OUTPUT WATTAGE 4 x (96W ~ 288W)  
OUTPUT CHANNELS 4  
DIMENSIONS LxWxH (7"x1.77"x0.75")

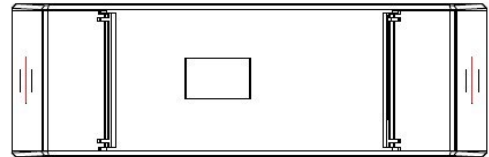

---

#### RGB-DMX-5C-XLR 5-CHANNEL DMX DECODER

INPUT VOLTAGE 12V-24V DC  
OUTPUT CURRENT 8A X 5CH  
OUTPUT WATTAGE 5 x (96W ~ 192W)  
OUTPUT CHANNELS 5  
DIMENSIONS LxWxH (6.45"x2.87"x1.5")

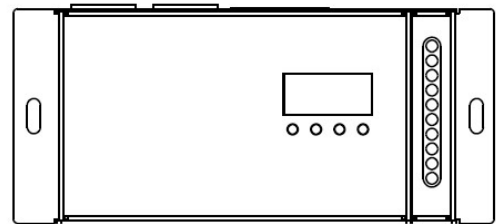

# LSM-55 RGBW

## 5W INDOOR COLOR-CHANGING + WHITE LED STRIP

### NON-DMX CONTROLLERS

#### RGB-CT550

RGBW WIRELESS RECEIVER / CONTROLLER SYSTEM

REMOTE DISTANCE	100 Ft. (Line of Sight)
FREQUENCY	2.4 GHz
DIMENSIONS	LxWxH (6.38"x1.65"x0.59")
WEIGHT	0.44lbs.



\* RGB-CT500-RX  
(Sold Separately)

#### RGB-CT550-RX

RGBW WIRELESS RECEIVER / CONTROLLER SYSTEM

INPUT VOLTAGE	DC5V ~ DC24V
POWER CAPACITY	100W (5V)   240W (12V)   480W (24V)
OUTPUT CURRENT	5A per Channel (20A Total)
WORKING TEMP	-30°C~55°C (-22°F~131°F)
DIMENSIONS	LxWxH (6.89"x1.73"x1.18")

\* RGB-CT500-RX (Sold Separately)

#### RGB-CT700

MASTER RGBW WIFI CONTROLLER

INPUT VOLTAGE	12-24V DC
OUTPUT TYPE	Constant Voltage
POWER CAPACITY	288W (12V)   384W (24V)
OUTPUT CURRENT	5A per Channel (20A Total)
WORKING TEMP	-4°F (-20°C) ~ 122°F (50°C)
DIMENSIONS	LxWxH (7 x1.8 x 0.8")

\* Paired with RGB-CT705ZR (Sold Separately)

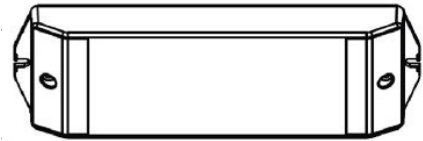

#### RGB-CT705ZR

SLAVE RGBW WIFI CONTROLLER

INPUT VOLTAGE	12-24V DC
OUTPUT TYPE	Constant Voltage
POWER CAPACITY	288W (12V)   384W (24V)
OUTPUT CURRENT	5A per Channel (20A Total)
WORKING TEMP	-4°F (-20°C) ~ 122°F (50°C)
DIMENSIONS	LxWxH (7 x0.63 x 0.71")

\* Paired with RGB-CT700 (Sold Separately)

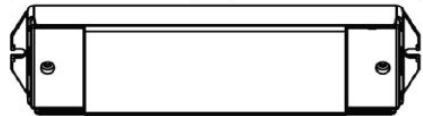

# LSM-55 RGBW

## 5W INDOOR COLOR-CHANGING + WHITE LED STRIP

### NON-DMX CONTROLLERS (CONTINUED)

**RGB-CT840**  
BLUETOOTH TOUCH PANEL WALL CONTROLLER

**INPUT VOLTAGE** 12-24V DC  
**ZONES** 4  
**CONTROL MODE** RGB | RGBW  
**WIRELESS PROTOCOL** Bluetooth 5.0 SIG Mesh  
**WORKING TEMP** -20°C ~ 55°C  
**DIMENSIONS** LxWxH (4.7"x3"x1.2")

*\* Paired with RGB-CT800-RC (Sold Separately)*



**RGB-CT800-RC**  
BLUETOOTH CONSTANT VOLTAGE LED RECEIVER

**INPUT VOLTAGE** 12V | 24V  
**OUTPUT CURRENT** 4Ax5CH / 5Ax4CH (20A Max)  
**POWER CAPACITY** 240W (12V) | 480W (24V)  
**PROGRAMMABILITY** iOS and Android  
**WORKING TEMP** -20°C ~ 55°C  
**DIMENSIONS** LxWxH (6.9 x1.7 x 1.2")

*\* Paired with RGB-CT840 (Sold Separately)*



### NON-DIMMING DRIVERS (COMPATIBLE WITH ALL SYSTEMS)

**PSHK SERIES**  
NON-DIMMING CONSTANT VOLTAGE WITH JUNCTION BOX

<b>PSHK-30W-24V</b>	<b>CLASS 2</b>	6.5" X 3.6" X 1.02"
<b>PSHK-60W-24V</b>	<b>CLASS 2</b>	7.4" X 3.62" X 1.02"
<b>PSHK-96W-24V</b>	<b>CLASS 2</b>	8.66" X 3.66" X 1.61"
<b>PSHK-150W-24V</b>		10.24" X 4.06" X 1.81"
<b>PSHK-200W-24V</b>		10.24" X 4.06" X 1.81"
<b>PSHK-288W-24V</b>	<b>CLASS 2</b>	11.85" X 4.25" X 1.82"
<b>PSHK-300W-24V</b>		10.24" X 4.25" X 1.81"

