

LSXT-250

2.2W LONG RUN OUTDOOR FLEXIBLE LED STRIP

Project _____
Location _____
Quote/ Ref # _____

The **LSXT-250** series is a dimmable, flexible LED strip capable of delivering up to 235 Lumens of light output per foot. It is cuttable every 3.92" and can reach a maximum of 64 Ft. in a single, continuous run. This innovative strip delivers consistent brightness with superior color rendering in a very efficient package.

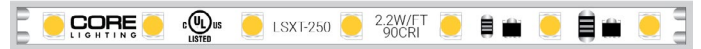

SPECIFICATIONS

| | |
|-----------------------|--------------------------------|
| INPUT VOLTAGE | 24V DC |
| POWER CONSUMPTION | 2.2W/Ft. |
| NO. OF LEDS | 21 LEDs per Ft. |
| LUMEN OUTPUT | 235 Lumens per foot (30K) |
| CRI | 95+ |
| COLOR TEMPERATURE | 27K/ 30K/ 40K |
| DIMMING | MLV, ELV, 0-10V and TRIAC |
| MAXIMUM RUN LENGTH | 64 Ft. |
| CUTTABLE | Every 3.92 in (99.5mm) |
| OPERATING TEMPERATURE | -40°F (-40°C) ~ +140°F (+60°C) |
| STORAGE TEMPERATURE | -22°F(-30°C)~+176°F(+80°C) |
| BEAM ANGLE | 120° |
| IP RATING | IP65 wet location (outdoor) |
| CERTIFICATIONS | UL Listed, TITLE 24 JA8 |
| LUMEN MAINTENANCE | 50,000 Hrs |

FEATURES

- 2.2W/Ft.
- 24V Low-Voltage LED Strip
- Suitable for accent or ambient lighting
- Multiple CCT options available
- Superior COLOR RENDERING INDEX (CRI)
- Dimmable with CORE Lighting Dimming Drivers
- UL Listed

*Approved for closet / storage space installation per NEC 410.16(A)(3) and 410.16(C)(5)



| MODEL | COLOR TEMP | LENGTH | VOLTAGE |
|---------|---------------------|--|---------------------|
| LSXT250 | 27K 2700K | 100 100 Ft. | 24 24V DC |
| | 30K 3000K | 325 325 Ft. | |
| | 40K 4000K | 1'XX Per Ft. | |
| | | *1 = Custom length per FT. (Cuttable every 3.92") | |

LSXT-250

2.2W LONG RUN OUTDOOR FLEXIBLE LED STRIP

DIMENSIONS

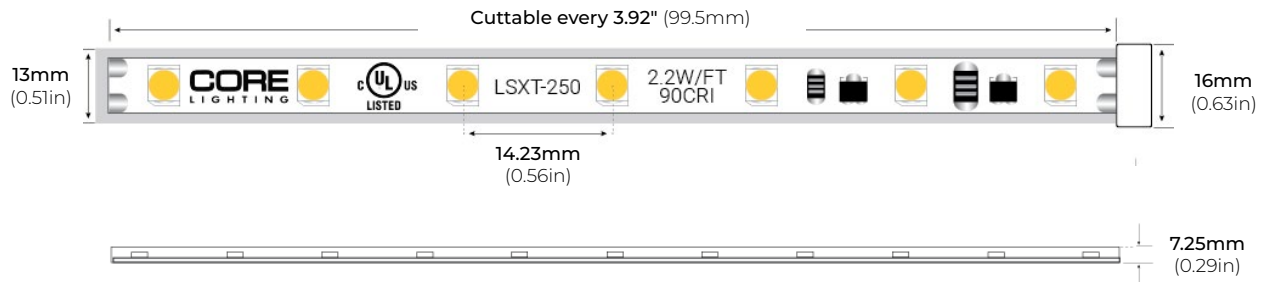

COMPATIBLE ACCESSORIES

LSXT-EC
END CAP

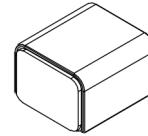

ALU-CN (CORNER)

LENGTHS 39" | 78" | 84" | 96"
LENS Clear, Frosted
FINISH Black | Silver

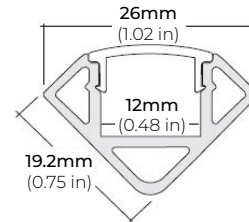

ALUMINUM CHANNEL

LSXT-AC2
2" ALUMINUM CHANNEL

LSXT-AC48
48" ALUMINUM CHANNEL

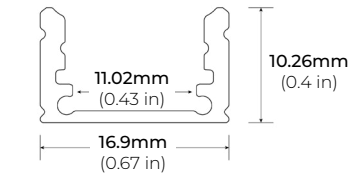

EXTENSION COUPLING

LSXT-EX3 3" LINK CABLE
LSXT-EX8 8" LINK CABLE
LSXT-EX24 24" LINK CABLE

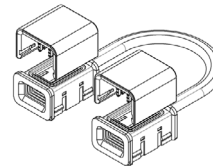

HARDWIRE CONNECTOR

LSXT-HW24 24" HARDWIRE CONNECTOR
LSXT-HW60 60" HARDWIRE CONNECTOR
LSXT-HW120 120" HARDWIRE CONNECTOR

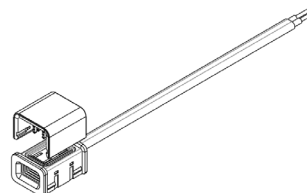

LSXT-250

2.2W LONG RUN OUTDOOR FLEXIBLE LED STRIP

COMPATIBLE TRANSFORMERS

PSDL SERIES TRIAC DIMMABLE

| | | |
|---------------|---------|------------------------|
| PSDL-30W-24V | CLASS 2 | 6.5" X 3.63" X 1.03" |
| PSDL-60W-24V | CLASS 2 | 7.4" X 3.63" X 1.03" |
| PSDL-96W-24V | CLASS 2 | 8.67" X 3.67 X 1.62" |
| PSDL-150W-24V | | 8.67" X 3.67" X 1.62" |
| PSDL-192W-24V | CLASS 2 | 10.25" X 4.06" X 1.82" |
| PSDL-200W-24V | | 10.25" X 4.06" X 1.82" |
| PSDL-288W-24V | CLASS 2 | 10.25" X 4.06" X 1.82" |
| PSDL-300W-24V | | 10.25" X 4.06" X 1.82" |

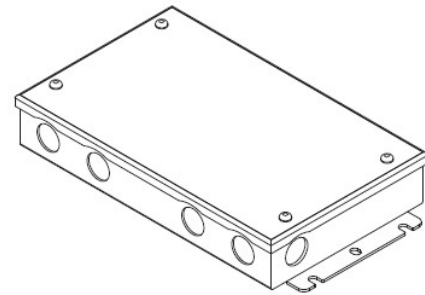

PSDH SERIES HIGH PERFORMANCE MAGNETIC LOW VOLTAGE (MLV)

| | | |
|---------------|---------|------------------------|
| PSDH-48W-24V | CLASS 2 | 11.25" X 3.37" X 3.25" |
| PSDH-96W-24V | CLASS 2 | 11.25" X 3.37" X 3.25" |
| PSDH-288W-24V | CLASS 2 | 14.25" X 8.43" X 4.43" |

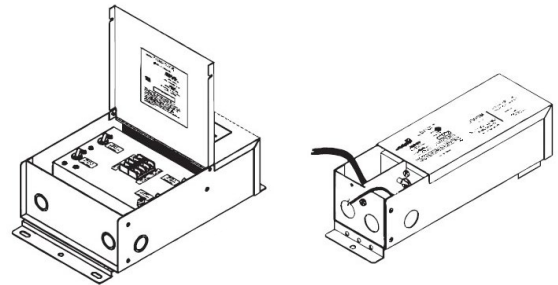

PSRX SERIES 4-IN-1 DIMMING DRIVER

| | | |
|---------------|---------|------------------------|
| PSRX-30W-24V | CLASS 2 | 6.5" X 3.72" X 1.57" |
| PSRX-60W-24V | CLASS 2 | 7.4" X 3.72" X 1.57" |
| PSRX-96W-24V | CLASS 2 | 8.66" X 3.72" X 1.57" |
| PSRX-150W-24V | | 10.24" X 4.13" X 1.77" |
| PSRX-192W-24V | CLASS 2 | 11" X 4" X 1.82" |
| PSRX-200W-24V | | 10.24" X 4.13" X 1.77" |
| PSRX-288W-24V | CLASS 2 | 11.85" X 4.25" X 1.82" |
| PSRX-300W-24V | | 10.94" X 4.33" X 1.77" |

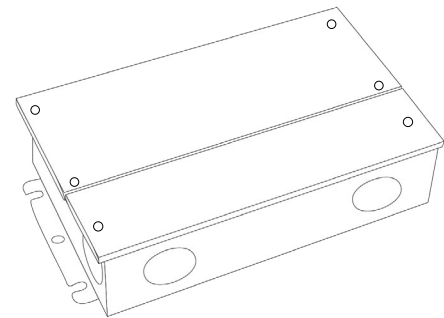

PSVT SERIES 0-10V DIMMING DRIVER

| | | |
|---------------|---------|------------------------|
| PSVT-60W-24V | CLASS 2 | 7.4" X 3.72" X 1.57" |
| PSVT-96W-24V | CLASS 2 | 8.66" X 3.72" X 1.57" |
| PSVT-200W-24V | | 10.24" X 4.13" X 1.77" |
| PSVT-288W-24V | CLASS 2 | 11.85" X 4.25" X 1.81" |
| PSVT-300W-24V | | 10.94" X 4.33" X 1.77" |

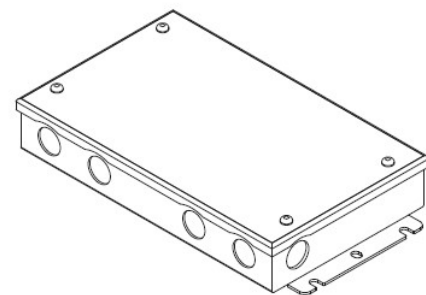

LSXT-250

2.2W LONG RUN OUTDOOR FLEXIBLE LED STRIP

COMPATIBLE TRANSFORMERS

PSDE SERIES
0-10V DIMMING W/ JUNCTION BOX

PSDE-60W-24V-010-JB CLASS 2 12.1" X 2.36" X 1.4"
PSDE-96W-24V-010-JB CLASS 2 12.1" X 2.36" X 1.4"

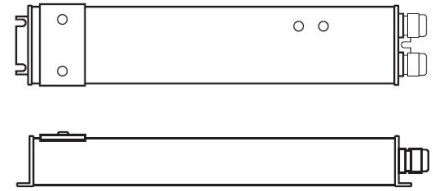

LUTRON 1%
3-WIRE DIMMING

L3DA4U1UKL-CV240 CLASS 2 4.89" X 4" X 2.62"

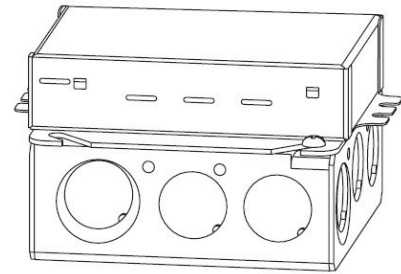

LUTRON 1%
3-WIRE DIMMING

PSDE-96W-24V-ECO CLASS 2 10.5" X 3.0" X 2.0"

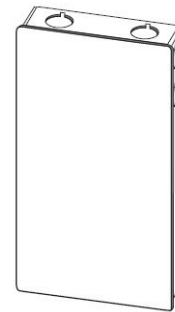

COMPATIBLE NON-DIMMING DRIVERS

PSHK SERIES
NON-DIMMING CONSTANT VOLTAGE WITH JUNCTION BOX

PSHK-30W-24V CLASS 2 6.5" X 3.6" X 1.02"
PSHK-60W-24V CLASS 2 7.4" X 3.62" X 1.02"
PSHK-96W-24V CLASS 2 8.66" X 3.66" X 1.61"
PSHK-150W-24V 10.24" X 4.06" X 1.81"
PSHK-200W-24V 10.24" X 4.06" X 1.81"
PSHK-288W-24V CLASS 2 11.85" X 4.25" X 1.82"
PSHK-300W-24V 10.24" X 4.25" X 1.81"

