

# LSE-450

## 4.4W INDOOR ECO TAPE LIGHT

Project \_\_\_\_\_

Location \_\_\_\_\_

Quote/ Ref # \_\_\_\_\_

**LSE-450** is a dimmable flexible LED strip capable of delivering 347 lumens of light output per ft. Its high lumen output, excellent color rendering and color temperature options make it the perfect choice for almost any commercial or residential lighting application.

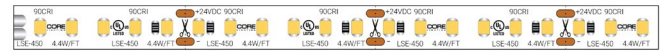

### SPECIFICATIONS

INPUT VOLTAGE	24V DC
POWER CONSUMPTION	4.4W per Ft.
LEDS/ FT.	36 LEDS per Ft.
LUMEN OUTPUT	347 Lumens per Ft.
CRI	90+
COLOR TEMPERATURE	27K/ 30K/ 40K
DIMMING	MLV, ELV, 0-10 and TRIAC
MAXIMUM RUN LENGTH	25Ft. (24V)
CUTTABLE	Every 2 In. (50.8")
OPERATING TEMPERATURE	-40°F(-40°C)~+140°F(+60°C)
BEAM ANGLE	120°
IP RATING	IP54 dry location (indoor)
CERTIFICATIONS	UL Listed
LUMEN MAINTENANCE	35,000 Hrs.

### FEATURES

- 24V
- 4.4W per Foot
- 347 Lumens
- 90+ CRI
- Field cuttable
- Suitable for accent or ambient lighting
- Multiple CCT options available
- UL Listed



MODEL	COLOR TEMP	LED LENGTH	VOLTAGE	PROFILE
LSE450	<b>27K</b> 2700K	<b>16</b> 16 Ft.	<b>24</b> 24V	See Page 3 - 4 for compatible profiles.
	<b>30K</b> 3000K	<b>100</b> 100 Ft.		
	<b>40K</b> 4000K			

\* Custom color finishes require powder coating. Allow 7 days leads time.

# LSE-450

## 4.4W INDOOR ECO TAPE LIGHT

### DIMENSIONS

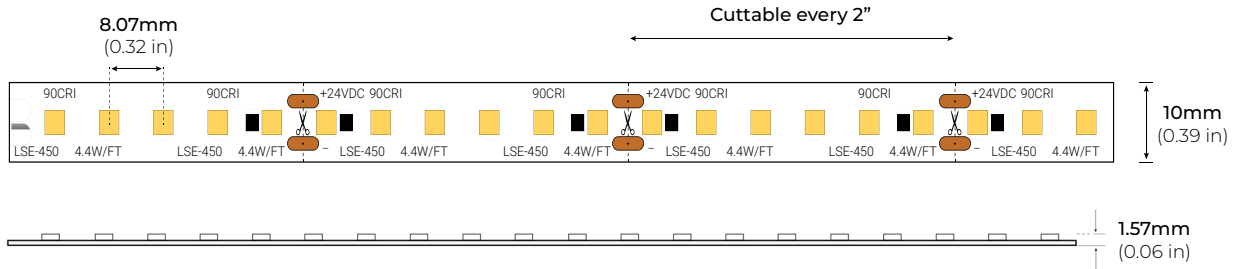

### COMPATIBLE CONNECTORS

#### HP PRO CONNECTORS

QUICK CONNECT SNAP-ON

LSA-HW8-HP 8" HARDWIRE CONNECTOR  
LSA-HW24-HP 24" HARDWIRE CONNECTOR  
LSA-HW60-HP 60" HARDWIRE CONNECTOR  
LSA-HW120-HP 120" HARDWIRE CONNECTOR

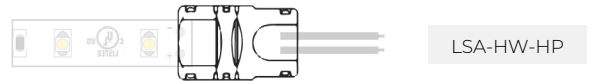

LSA-EX3-HP 3" LINK  
LSA-EX8-HP 8" LINK  
LSA-EX24-HP 24" LINK

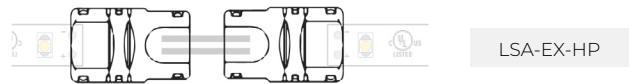

LSA-MC-HP MINI COUPLING



LSA-DC24-HP 24" DC CONNECTOR

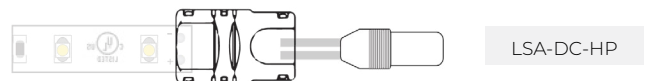

# LSE-450

## 4.4W INDOOR ECO TAPE LIGHT

### COMPATIBLE ALUMINUM PROFILES

#### SURFACE PROFILES

##### ALU-SF

LENGTHS 39" | 78" | 84" | 98"  
LENS Clear, Frosted  
FINISH Black | Silver

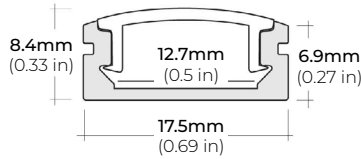

##### ALU-DS100

LENGTHS 39" | 78" | 84"  
LENS Clear, Frosted  
FINISH Silver

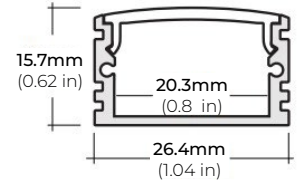

##### ALP-20

LENGTHS 49" | 84" | 98"  
LENS Frosted  
FINISH White | Black | Silver

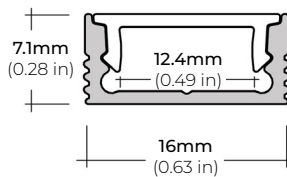

##### ALP-35

LENGTHS 49" | 98"  
LENS Frosted  
FINISH White | Black | Silver

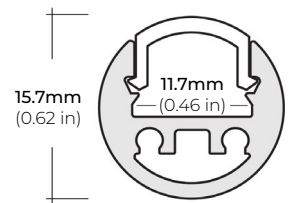

##### ALP-50C (CORNER)

LENGTHS 48" | 84" | 98"  
LENS Frosted  
FINISH White | Black | Silver

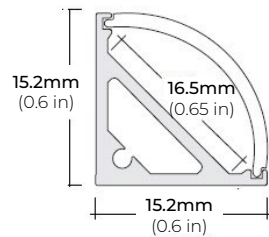

##### ALP-70

LENGTHS 49" | 84" | 98"  
LENS Frosted  
FINISH Black | Silver

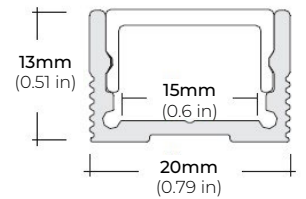

##### ALP-80

LENGTHS 49" | 98"  
LENS Frosted  
FINISH Silver

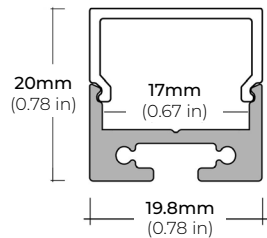

##### ALP-100C (CORNER)

LENGTHS 48" | 98"  
LENS Frosted  
FINISH Silver

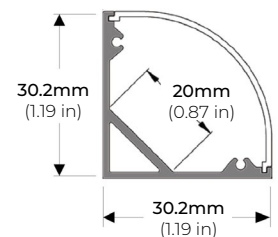

##### ALP-100K-98 (CORNER)

LENGTHS 48" | 98"  
LENS Frosted  
FINISH Silver

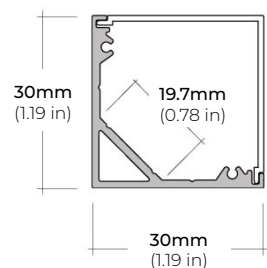

##### ALP-102

LENGTHS 49" | 98"  
LENS Frosted, Black, Asymmetric, Double Asymmetric  
FINISH Black | Silver | White

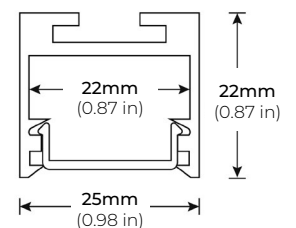

\* For more compatible profiles, visit [corelightingusa.com](http://corelightingusa.com)

# LSE-450

## 4.4W INDOOR ECO TAPE LIGHT

### COMPATIBLE ALUMINUM PROFILES

#### RECESSED PROFILES

##### ALP-70R

LENGTHS 48" | 98"  
LENS Frosted  
FINISH Black | Silver

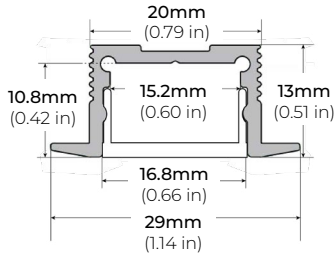

##### ALP-102R

LENGTHS 49" | 98"  
LENS Frosted, Black, Asymmetric, Double Asymmetric  
FINISH Silver

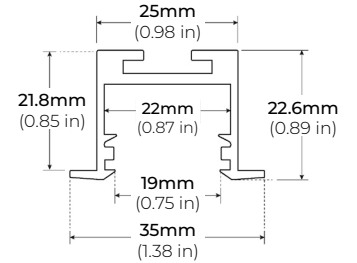

\* For more compatible profiles, visit [corelightingusa.com](http://corelightingusa.com)

#### TRIMLESS PROFILES

##### ALP-1300TL

LENGTHS 48" | 96"  
LENS Clear, Frosted  
FINISH White

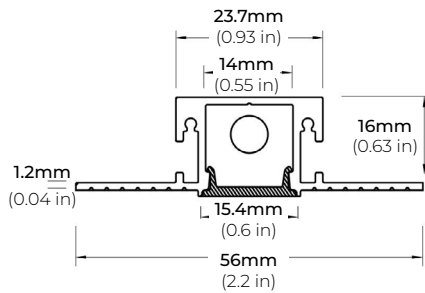

##### ALP-2300TL

LENGTHS 48" | 96"  
LENS Frosted  
FINISH White

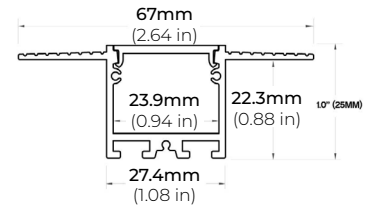

##### ALP-2400TL

LENGTHS 48" | 96"  
LENS Clear, Frosted  
FINISH White

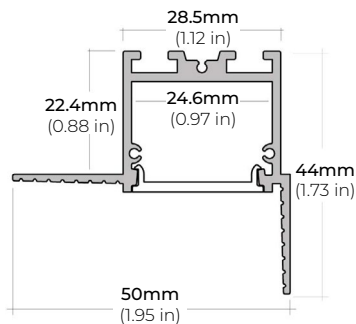

##### ALP-2700TL

LENGTHS 48" | 96"  
LENS Frosted  
FINISH White

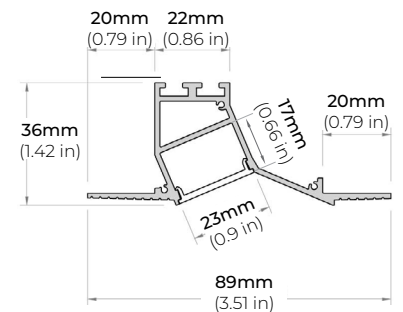

\* For more compatible profiles, visit [corelightingusa.com](http://corelightingusa.com)

# LSE-450

## 4.4W INDOOR ECO TAPE LIGHT

### COMPATIBLE TRANSFORMERS

#### PSDL SERIES TRIAC DIMMABLE

PSDL-30W-24V	CLASS 2	6.5" X 3.63" X 1.58"
PSDL-60W-24V	CLASS 2	7.4" X 3.63" X 1.58"
PSDL-96W-24V	CLASS 2	8.67" X 3.67 X 1.62"
PSDL-150W-24V		10.25" X 4.06" X 1.82"
PSDL-192W-24V	CLASS 2	11" X 4" X 1.82"
PSDL-200W-24V		10.25" X 4.06" X 1.82"
PSDL-288W-24V	CLASS 2	11.85" X 4.25" X 1.82"
PSDL-300W-24V		10.25" X 4.06" X 1.82"

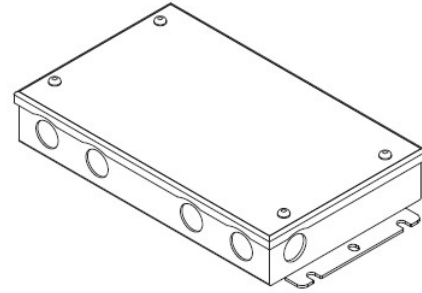

#### PSDH SERIES HIGH PERFORMANCE MAGNETIC LOW VOLTAGE (MLV)

PSDH-48W-24V	CLASS 2	11.25" X 3.38" X 3.38"
PSDH-96W-24V	CLASS 2	11.25" X 3.38" X 3.37"
PSDH-288W-24V	CLASS 2	14.25" X 8.43" X 4.43"

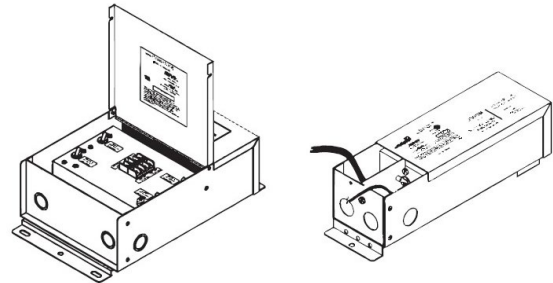

#### PSRX SERIES 4-IN-1 DIMMING DRIVER W/ JUNCTION BOX

PSRX-30W-24V-UNV	CLASS 2	6.5" X 3.7" X 1.57"
PSRX-60W-24V-UNV	CLASS 2	7.4" X 3.72" X 1.57"
PSRX-96W-24V-UNV	CLASS 2	8.66" X 3.72" X 1.57"
PSRX-150W-24V-UNV		10.24" X 4.13" X 1.77"
PSRX-200W-24V-UNV		10.24" X 4.13" X 1.77"
PSRX-300W-24V-UNV		10.94" X 4.33" X 1.77"

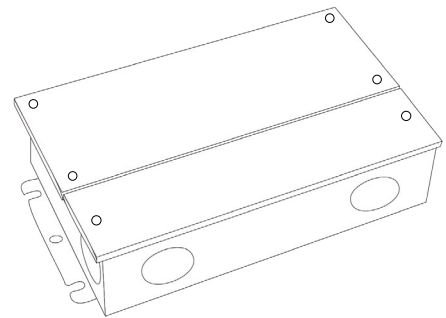

#### PSVT SERIES 0-10V DIMMING WITH JUNCTION BOX

PSVT-60W-24V-UNV-010	CLASS 2	7.4" X 3.72" X 1.57"
PSVT-96W-24V-UNV-010	CLASS 2	8.66" X 3.72" X 1.57"
PSVT-200W-24V-UNV-010		10.24" X 4.13" X 1.77"
PSVT-288W-24V-UNV-010	CLASS 2	11.85" X 4.25" X 1.81"
PSVT-300W-24V-UNV-010		10.94" X 4.33" X 1.77"

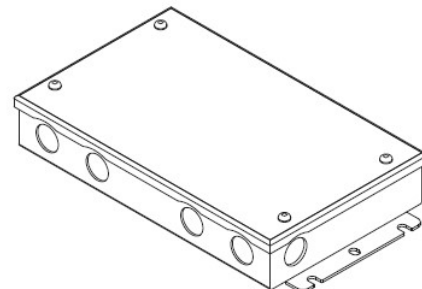

# LSE-450

## 4.4W INDOOR ECO TAPE LIGHT

### COMPATIBLE TRANSFORMERS

PSDE SERIES  
0-10V DIMMING W/ JUNCTION BOX

PSDE-60W-24V-010-JB CLASS 2 12.1" X 2.36" X 1.4"  
PSDE-96W-24V-010-JB CLASS 2 12.1" X 2.36" X 1.4"

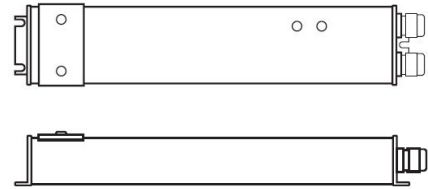

LUTRON 1%  
3-WIRE DIMMING

L3DA4U1UKL-CV240 CLASS 2 4.89" X 4" X 2.62"

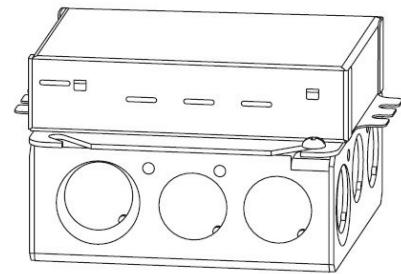

LUTRON 1%  
3-WIRE DIMMING

PSDE-96W-24V-ECO CLASS 2 10.5" X 3.0" X 2.0"

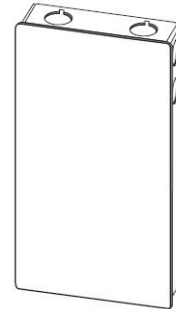

### COMPATIBLE NON-DIMMING DRIVERS

PSHK SERIES  
NON-DIMMING CONSTANT VOLTAGE WITH JUNCTION BOX

PSHK-30W-24V CLASS 2 6.5" X 3.6" X 1.02"  
PSHK-60W-24V CLASS 2 7.4" X 3.62" X 1.02"  
PSHK-96W-24V CLASS 2 8.66" X 3.66" X 1.61"  
PSHK-150W-24V 10.24" X 4.06" X 1.81"  
PSHK-200W-24V 10.24" X 4.06" X 1.81"  
PSHK-288W-24V CLASS 2 11.85" X 4.25" X 1.82"  
PSHK-300W-24V 10.94" X 4.25" X 1.81"

