

LSP-70 RGBWW

7W INDOOR COLOR CHANGING + WHITE LED STRIP

Project _____
Location _____
Quote/ Ref # _____

LSP-70 RGBWW series is an innovative new flexible color-changing LED strip that provides a full dynamic range of color options layered with color tuning white. It is compatible with DMX systems for single or multiple zone control.



SPECIFICATIONS

INPUT VOLTAGE	24V DC
POWER CONSUMPTION	7W/FT
LUMEN OUTPUT	Up to 260 Lm/ Ft.
CRI	95+
COLOR TEMPERATURE	27K/50K 30K/50K
DIMMING	Through DMX Controller
MAXIMUM RUN LENGTH	22FT
CUTTABLE	Every 2.4" (61.8mm)
OPERATING TEMPERATURE	5°C (41°F) to 70°C (158°F)
AMBIENT TEMPERATURE	-20°C (4°F) to 40°C (108°F)
BEAM ANGLE	120°
IP RATING	IP20 (Indoor)
CERTIFICATIONS	UL Listed, California TITLE 24 JA8
LUMEN MAINTENANCE	50,000 Hrs.

FEATURES

- Available in 24V
- 7W
- 95+ CRI
- Full range RGB + color-tuning white
- Designed for easy installation
- Fully compatible with DMX systems
- Indoor (dry) location rated
- UP to 22 FT continuous run
- California TITLE 24 JA8 compliant
- Field cuttable
- Suitable for accent or ambient lighting
- Multiple CCT options available
- Superior COLOR RENDERING INDEX (CRI)



MODEL	COLOR TEMP	LENGTH	VOLTAGE	PROFILE
LSP70-RGBWW	27K/50K 2700K-5000K	16 16 Ft.	24 24V DC	See Pages 2 for compatible profiles.
	30K/50K 3000K-5000K	100 100Ft.		
		XX Per Ft.		

LSP-70 RGBWW

7W INDOOR COLOR CHANGING + WHITE LED STRIP

DIMENSIONS

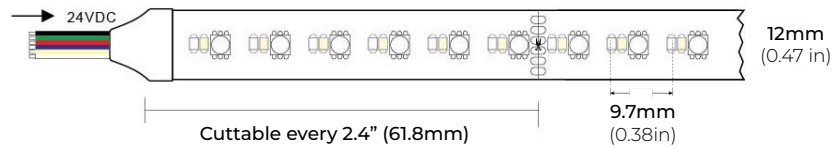

COMPATIBLE ALUMINUM PROFILES

SURFACE PROFILES

ALU-SF

LENGTHS 39" | 78" | 84" | 98"
LENS Clear, Frosted
FINISH Black | Silver

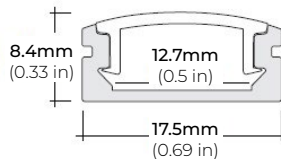

ALU-DS100

LENGTHS 39" | 78" | 84"
LENS Clear, Frosted
FINISH Silver

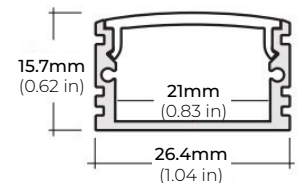

ALU-CN (CORNER)

LENGTHS 39" | 78" | 84" | 96"
LENS Clear, Frosted
FINISH Black | Silver

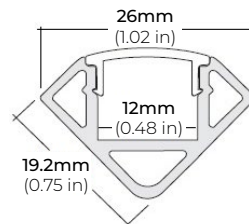

ALP-70

LENGTHS 49" | 84" | 98"
LENS Frosted
FINISH White | Black | Silver

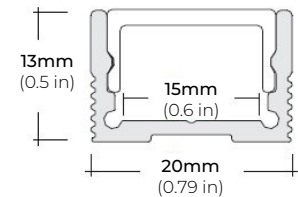

ALP-75C (CORNER)

LENGTHS 49" | 84" | 98"
LENS Frosted
FINISH Black | Silver

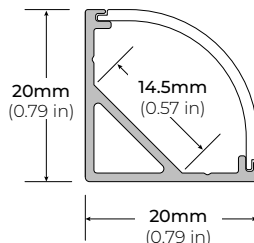

ALP-80

LENGTHS 49" | 98"
LENS Frosted
FINISH Silver

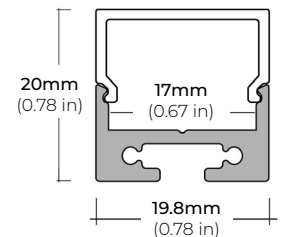

ALP-100C

LENGTHS 48" | 98"
LENS Frosted
FINISH Silver

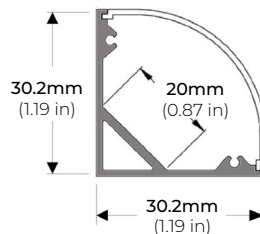

ALP-130

LENGTHS 49" | 84" | 98"
LENS Frosted
FINISH Silver

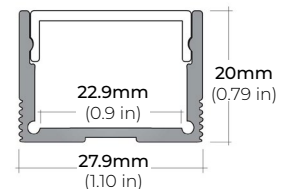

* For more compatible profiles, visit corelightingusa.com

RECESSED PROFILES

ALP-70R

LENGTHS 48" | 98"
LENS Frosted
FINISH White | Black | Silver

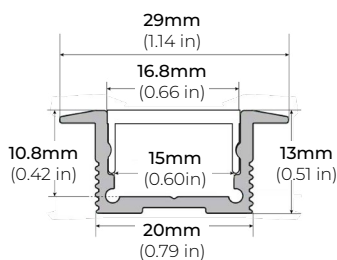

ALP-102R

LENGTHS 49" | 98"
LENS Frosted, Black, Asymmetric, Double Asymmetric
FINISH Silver

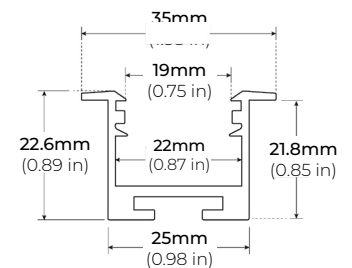

* For more compatible profiles, visit corelightingusa.com

LSP-70 RGBWW

7W INDOOR COLOR CHANGING + WHITE LED STRIP

DMX CONTROLLERS

RGB-SCW4

WiFi DMX WALL CONTROLLER

INPUT VOLTAGE	5 - 10V DC, 06A
OUTPUT SIGNAL	DMX512 (x2)
PROGRAMMABILITY	PC/ MAC
COLOR OPTIONS	Black/ White
CONNECTIONS	USB/ 8dry contact ports/ Open drain output (for relay)
MEMORY	Built-In Flash
WORKING TEMP	-10°C ~ 45°C
DIMENSIONS	LxWxH (5.75"x4.17"x0.43")

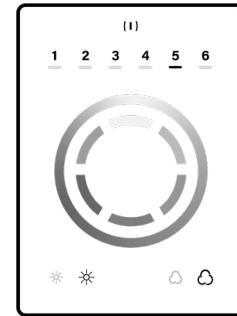

RGB-SDE3

WiFi DMX WALL CONTROLLER

INPUT VOLTAGE	6V DC, 0.6A
OUTPUT SIGNAL	DMX512 (x2)
PROGRAMMABILITY	PC/ MAC/ Tablet/ Smartphone
COLOR OPTIONS	Black/ White
CONNECTIONS	USB/ Ethernet/ RS232/ CLock/ 8dry contact ports/ 5V output relay
MEMORY	MicroSD Card
WORKING TEMP	-20°C ~ 40°C
DIMENSIONS	LxWxH (5.75"x4.17"x0.43")

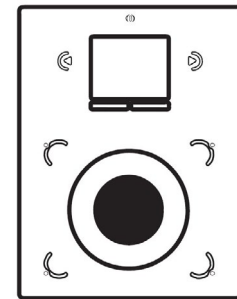

DMX DECODERS

RGB-DMX-5C-XLR

5-CHANNEL DMX DECODER

INPUT VOLTAGE	12V-24V DC
OUTPUT CURRENT	8A X 5CH
OUTPUT WATTAGE	5 x (96W ~ 192W)
OUTPUT CHANNELS	5
DIMENSIONS	LxWxH (6.45"x2.87"x1.5")

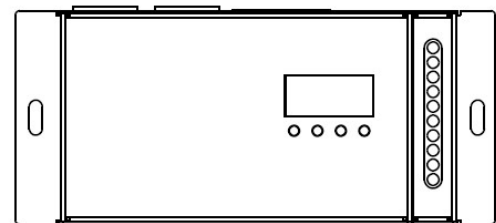

LSP-70 RGBWW

7W INDOOR COLOR CHANGING + WHITE LED STRIP

BASIC CONTROLLERS

RGB-CT850
RGBW BLUETOOTH TOUCH PANEL WALL CONTROLLER

INPUT VOLTAGE 12-24V DC
ZONES 4
CONTROL MODE RGBW | RGBW+W
WIRELESS PROTOCOL Bluetooth 5.0 SIG Mesh
WORKING TEMP -20°C ~ 55°C
DIMENSIONS LxWxH (4.7"x3"x1.2")

** Paired with RGB-CT800 (Sold Separately)*



COMPATIBLE BASIC RECEIVERS

RGB-CT800-RC
BLUETOOTH CONSTANT VOLTAGE LED RECEIVER

INPUT VOLTAGE 12V | 24V
OUTPUT CURRENT 4Ax5CH / 5Ax4CH (20A Max)
POWER CAPACITY 240W (12V) | 480W (24V)
PROGRAMMABILITY iOS and Android
WORKING TEMP -20°C ~ 55°C
DIMENSIONS LxWxH (6.9 x1.7 x 1.2")

** Paired with RGB-CT850 (Sold Separately)*



COMPATIBLE NON-DIMMING DRIVERS

PSHK SERIES
NON-DIMMING CONSTANT VOLTAGE WITH JUNCTION BOX

PSHK-30W-24V	CLASS 2	6.5" X 3.6" X 1.02"
PSHK-60W-24V	CLASS 2	7.4" X 3.62" X 1.02"
PSHK-96W-24V	CLASS 2	8.66" X 3.66" X 1.61"
PSHK-150W-24V		10.24" X 4.06" X 1.81"
PSHK-200W-24V		10.24" X 4.06" X 1.81"
PSHK-288W-24V	CLASS 2	11.85" X 4.25" X 1.82"
PSHK-300W-24V		10.24" X 4.25" X 1.81"

