

# LNT-45

## 4.4W IP67/68 FLEXIBLE LED NEON SERIES

Project \_\_\_\_\_

Location \_\_\_\_\_

Quote/ Ref # \_\_\_\_\_

**LNT45** is a high performance flexible LED fixture designed as a neon replacement. Suitable for indoor and outdoor applications, the LNT45 easily bends around contours and tight curves without being damaged. It allows for easy installation with its factory sealed terminators and self-locking male and female barrel connectors.

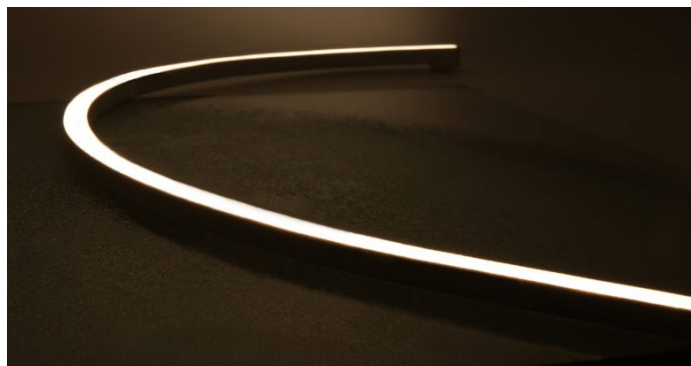

### SPECIFICATIONS

|                       |  |
|-----------------------|--|
| INPUT VOLTAGE         | 24V DC Constant Voltage                                |
| POWER CONSUMPTION     | 4.4W per Ft.   |
| LUMEN OUTPUT          | 140 Lm/ Ft. (Flat)   115 Lm/ Ft. (Dome)                |
| CRI                   | 88+  |
| COLOR TEMPERATURE     | 22K/ 27K/ 30K/ 35K/ 40K/ 50K<br>RD/ GN/ BL/ AM/ PK/ YW |
| DIMMING/ CONTROL      | MLV, ELV, 0-10 and TRIAC                               |
| MAXIMUM RUN LENGTH    | 32 Ft.   |
| CUTTABLE              | Every 100.1mm (3.94 in)                                |
| POWER FACTOR          | ≤1   |
| STORAGE TEMPERATURE   | -40°F (-40°C) to 140°F (60°C)                          |
| OPERATING TEMPERATURE | -40°F (-40°C) to 131°F (55°C)                          |
| BEAM ANGLE            | 160° (Flat)   270° (Dome)                              |
| HUMIDITY              | 0-95% Non Condensing                                   |
| IP RATING             | IP67/ IP68   |
| CERTIFICATIONS        | UL Listed  |
| LUMEN MAINTENANCE     | 50,000 Hrs.  |

### FEATURES

- High color consistency
- Smooth illumination
- Continuous run length up to 32 Ft.
- Waterproof, submersible under water
- Bottom, Side and End Feed options
- UL Listed



| MODEL               | LENS                | COLOR TEMPERATURE   |                     | VOLTAGE             | LENGTH  | POWER FEED                       | FEED LENGTH                      |
|---------------------|---------------------|---------------------|---------------------|---------------------|---|----------------------------------|----------------------------------|
| LNT-45              | F<br>Flat           | <b>22K</b><br>2700K | <b>RD</b><br>Red    | <b>24</b><br>24V DC | Please refer to page 4 for exact lengths with corresponding ordering codes. | <b>BF</b><br>Bottom Feed         | <b>HW3</b><br>3 Ft. Power Feed   |
|                     |                     | D<br>Dome           | <b>27K</b><br>2700K |                     |   | <b>GN</b><br>Green               | <b>SFL</b><br>Side Feed Left     |
|                     | <b>30K</b><br>3000K |                     | <b>BL</b><br>Blue   |                     |   | <b>SFR</b><br>Side Feed Right    | <b>HW16</b><br>16 Ft. Power Feed |
|                     | <b>35K</b><br>3500K |                     | <b>AM</b><br>Amber  |                     |   |                                  | <b>EF</b><br>End Feed            |
|                     | <b>40K</b><br>4000K |                     | <b>PK</b><br>Pink   |                     |   | <b>HW50</b><br>50 Ft. Power Feed |                                  |
|                     | <b>50K</b><br>5000K | <b>YW</b><br>Yellow |                     |                     |   |                                  |                                  |
| <b>60K</b><br>6000K |                     |                     |                     |                     |   |                                  |                                  |

# LNT-45

## 4.4W IP67/68 FLEXIBLE LED NEON SERIES

### DIMENSIONS

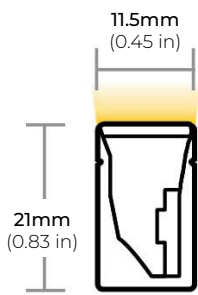

FLAT LENS

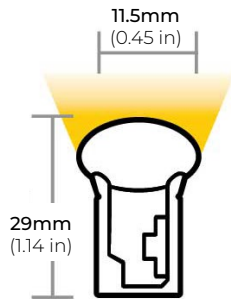

DOME LENS

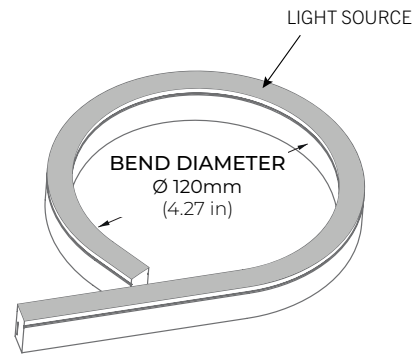

### HORIZONTAL BEND

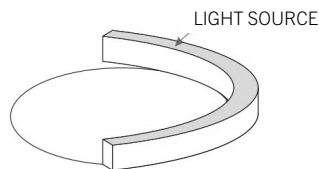
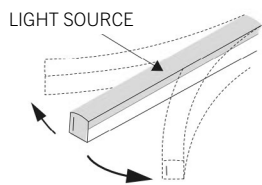

\* LED strip only bends along horizontal axis. Bending the LED strip vertically (perpendicular) to the light surface risks damage to the LED strip. Do **NOT** bend more than the indicated bend radius (shown above). Doing so will damage the LED strip.

### COMPATIBLE ACCESSORIES

#### SELF LOCKING ALUMINUM PROFILE

LNT45-AC2  
2" PROFILE

LNT45-AC39  
39" PROFILE

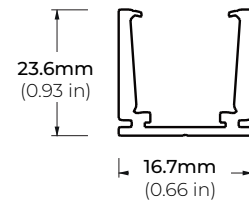

#### FLEXIBLE ALUMINUM CHANNEL

LNT45-AFX  
39" CHANNEL

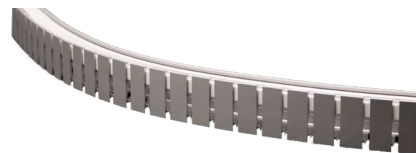

#### PLASTIC PROFILE

LNT45-PC39  
39" PROFILE

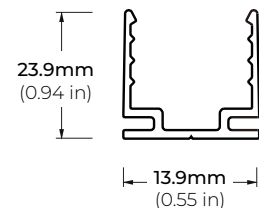

LNT45-BKT-ADJ  
ADJUSTABLE BRACKET

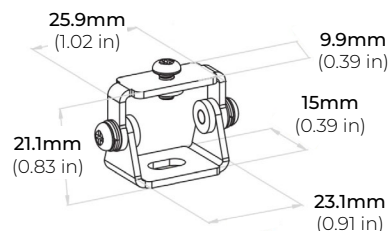

# LNT-45

## 4.4W IP67/68 FLEXIBLE LED NEON SERIES

### POWER FEED

#### FLAT

#### DOME

EF  
END FEED

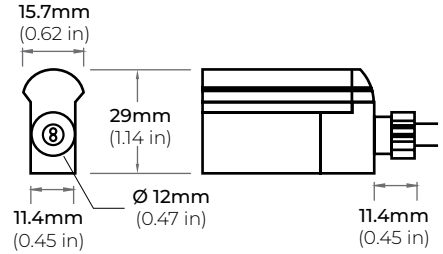
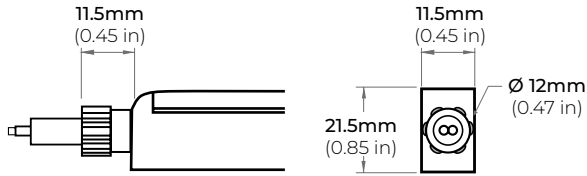

SFL  
SIDE FEED LEFT

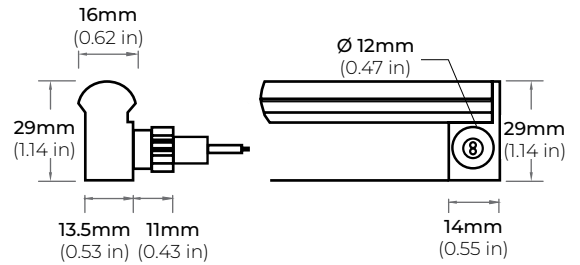
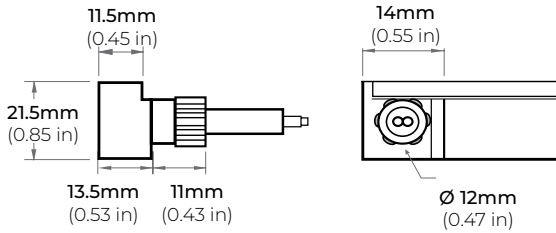

SFR  
SIDE FEED RIGHT

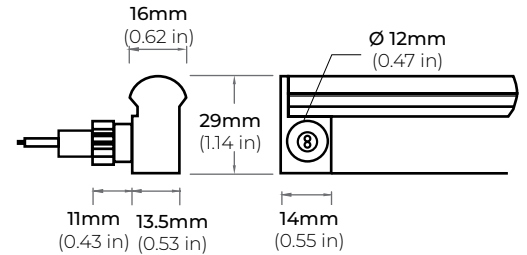
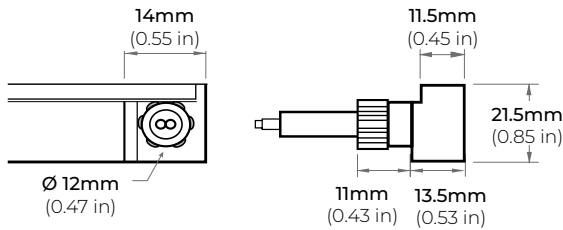

BF  
BOTTOM FEED

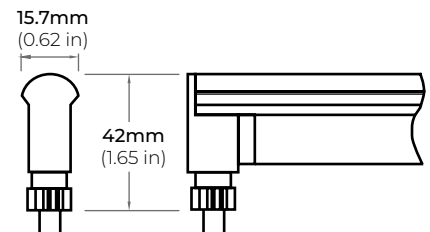
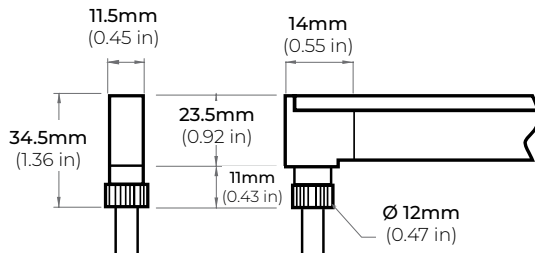

EC  
END CAP

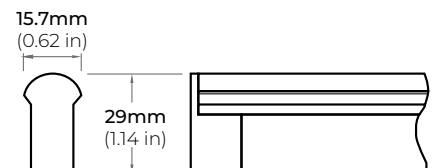
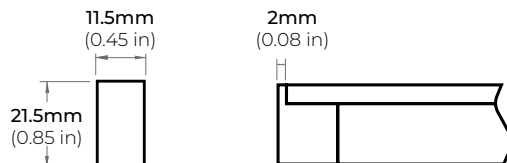

# LNT-45

## 4.4W IP67/68 FLEXIBLE LED NEON SERIES

### CUTTING LENGTH CODES

LNT-45 Series is cuttable every 3.94" (10CM). Please refer to the chart below to determine actual lengths once LED is cut versus actual lengths required or specified.

Total Length Calculation = Order Code Length + End Feed option Length  
**Example: 60.2" Total Length = Order Code 15 (59.1") + (1.1") End Feed**

| POWER FEED OPTION |       |
|-------------------|-------|
| END FEED          | 1.1"  |
| BOTTOM FEED       | 0.20" |
| SIDE FEED         | 0.20" |

### CUTTING LENGTH INCREMENT TABLE

| CODE | LENGTH (CM) | LENGTH (IN) |
|------|-------------|-------------|
| 1    | 10          | 3.94        |
| 2    | 20          | 7.88        |
| 3    | 30          | 11.82       |
| 4    | 40          | 15.76       |
| 5    | 50          | 19.7        |
| 6    | 60          | 23.64       |
| 7    | 70          | 27.58       |
| 8    | 80          | 31.52       |
| 9    | 90          | 35.46       |
| 10   | 100         | 39.4        |
| 11   | 110         | 43.34       |
| 12   | 120         | 47.28       |
| 13   | 130         | 51.22       |
| 14   | 140         | 55.16       |
| 15   | 150         | 59.1        |
| 16   | 160         | 63.04       |
| 17   | 170         | 66.98       |
| 18   | 180         | 70.92       |
| 19   | 190         | 74.86       |
| 20   | 200         | 78.8        |
| 21   | 210         | 82.74       |
| 22   | 220         | 86.68       |
| 23   | 230         | 90.62       |
| 24   | 240         | 94.56       |
| 25   | 250         | 98.5        |
| 26   | 260         | 102.44      |
| 27   | 270         | 106.38      |
| 28   | 280         | 110.32      |
| 29   | 290         | 114.26      |
| 30   | 300         | 118.2       |
| 31   | 310         | 122.14      |
| 32   | 320         | 126.08      |
| 33   | 330         | 130.02      |
| 34   | 340         | 133.96      |
| 35   | 350         | 137.9       |
| 36   | 360         | 141.84      |
| 37   | 370         | 145.78      |
| 38   | 380         | 149.72      |
| 39   | 390         | 153.66      |
| 40   | 400         | 157.6       |

| CODE | LENGTH (CM) | LENGTH (IN) |
|------|-------------|-------------|
| 41   | 410         | 161.54      |
| 42   | 420         | 165.48      |
| 43   | 430         | 169.42      |
| 44   | 440         | 173.36      |
| 45   | 450         | 177.3       |
| 46   | 460         | 181.24      |
| 47   | 470         | 185.18      |
| 48   | 480         | 189.12      |
| 49   | 490         | 193.06      |
| 50   | 500         | 197         |
| 51   | 510         | 200.94      |
| 52   | 520         | 204.88      |
| 53   | 530         | 208.82      |
| 54   | 540         | 212.76      |
| 55   | 550         | 216.7       |
| 56   | 560         | 220.64      |
| 57   | 570         | 224.58      |
| 58   | 580         | 228.52      |
| 59   | 590         | 232.46      |
| 60   | 600         | 236.4       |
| 61   | 610         | 240.34      |
| 62   | 620         | 244.28      |
| 63   | 630         | 248.22      |
| 64   | 640         | 252.16      |
| 65   | 650         | 256.1       |
| 66   | 660         | 260.04      |
| 67   | 670         | 263.98      |
| 68   | 680         | 267.92      |
| 69   | 690         | 271.86      |
| 70   | 700         | 275.8       |
| 71   | 710         | 279.74      |
| 72   | 720         | 283.68      |
| 73   | 730         | 287.62      |
| 74   | 740         | 291.56      |
| 75   | 750         | 295.5       |
| 76   | 760         | 299.44      |
| 77   | 770         | 303.38      |
| 78   | 780         | 307.32      |
| 79   | 790         | 311.26      |
| 80   | 800         | 315.2       |

| CODE | LENGTH (CM) | LENGTH (IN) |
|------|-------------|-------------|
| 81   | 810         | 319.14      |
| 82   | 820         | 323.08      |
| 83   | 830         | 327.02      |
| 84   | 840         | 330.96      |
| 85   | 850         | 334.9       |
| 86   | 860         | 338.84      |
| 87   | 870         | 342.78      |
| 88   | 880         | 346.72      |
| 89   | 890         | 350.66      |
| 90   | 900         | 354.6       |
| 91   | 910         | 358.54      |
| 92   | 920         | 362.48      |
| 93   | 930         | 366.42      |
| 94   | 940         | 370.36      |
| 95   | 950         | 374.3       |
| 96   | 960         | 378.24      |
| 97   | 970         | 382.18      |
| 98   | 980         | 386.12      |
| 99   | 990         | 390.06      |
| 100  | 1000        | 394         |

# LNT-45

## 4.4W IP67/68 FLEXIBLE LED NEON SERIES

### COMPATIBLE TRANSFORMERS

#### PSDL SERIES TRIAC DIMMABLE

|               |         |                        |
|---------------|---------|------------------------|
| PSDL-30W-24V  | CLASS 2 | 6.5" X 3.63" X 1.03"   |
| PSDL-60W-24V  | CLASS 2 | 7.4" X 3.63" X 1.03"   |
| PSDL-96W-24V  | CLASS 2 | 8.67" X 3.67 X 1.62"   |
| PSDL-150W-24V |         | 8.67" X 3.67" X 1.62"  |
| PSDL-192W-24V | CLASS 2 | 10.25" X 4.06" X 1.82" |
| PSDL-200W-24V |         | 10.25" X 4.06" X 1.82" |
| PSDL-288W-24V | CLASS 2 | 10.25" X 4.06" X 1.82" |
| PSDL-300W-24V |         | 10.25" X 4.06" X 1.82" |

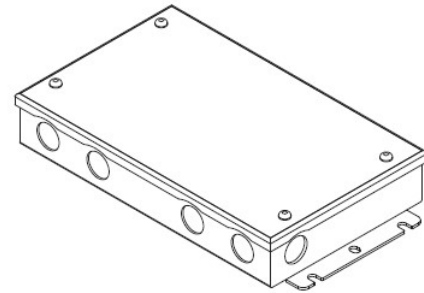

#### PSDH SERIES HIGH PERFORMANCE MAGNETIC LOW VOLTAGE (MLV)

|               |         |                        |
|---------------|---------|------------------------|
| PSDH-48W-24V  | CLASS 2 | 11.25" X 3.37" X 3.25" |
| PSDH-96W-24V  | CLASS 2 | 11.25" X 3.37" X 3.25" |
| PSDH-288W-24V | CLASS 2 | 14.25" X 8.43" X 4.43" |

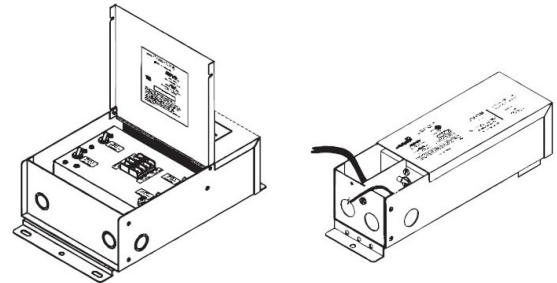

#### PSRX SERIES 4-IN-1 DIMMING DRIVER

|               |         |                        |
|---------------|---------|------------------------|
| PSRX-30W-24V  | CLASS 2 | 6.5" X 3.72" X 1.57"   |
| PSRX-60W-24V  | CLASS 2 | 7.4" X 3.72" X 1.57"   |
| PSRX-96W-24V  | CLASS 2 | 8.66" X 3.72" X 1.57"  |
| PSRX-150W-24V |         | 10.24" X 4.13" X 1.77" |
| PSRX-192W-24V | CLASS 2 | 11" X 4" X 1.82"       |
| PSRX-200W-24V |         | 10.24" X 4.13" X 1.77" |
| PSRX-288W-24V | CLASS 2 | 11.85" X 4.25" X 1.82" |
| PSRX-300W-24V |         | 10.94" X 4.33" X 1.77" |

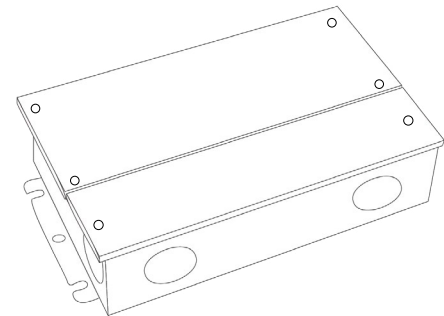

#### PSVT SERIES 0-10V DIMMING DRIVER

|               |         |                        |
|---------------|---------|------------------------|
| PSVT-60W-24V  | CLASS 2 | 7.4" X 3.72" X 1.57"   |
| PSVT-96W-24V  | CLASS 2 | 8.66" X 3.72" X 1.57"  |
| PSVT-200W-24V |         | 10.24" X 4.13" X 1.77" |
| PSVT-288W-24V | CLASS 2 | 11.85" X 4.25" X 1.81" |
| PSVT-300W-24V |         | 10.94" X 4.33" X 1.77" |

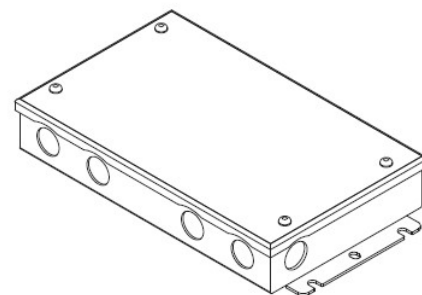

# LNT-45

## 4.4W IP67/68 FLEXIBLE LED NEON SERIES

### COMPATIBLE TRANSFORMERS

PSDE SERIES  
0-10V DIMMING W/ JUNCTION BOX

|                     |         |                      |
|---------------------|---------|----------------------|
| PSDE-60W-24V-010-JB | CLASS 2 | 12.1" X 2.36" X 1.4" |
| PSDE-96W-24V-010-JB | CLASS 2 | 12.1" X 2.36" X 1.4" |

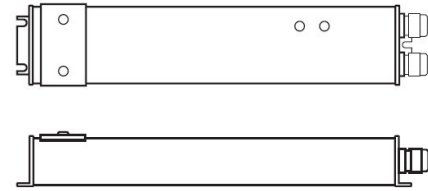

LUTRON 1%  
3-WIRE DIMMING

|                  |         |                    |
|------------------|---------|--------------------|
| L3DA4U1UKL-CV240 | CLASS 2 | 4.89" X 4" X 2.62" |
|------------------|---------|--------------------|

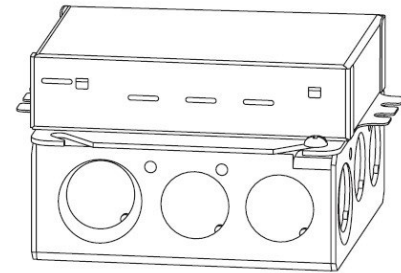

|                  |         |                     |
|------------------|---------|---------------------|
| PSDE-96W-24V-ECO | CLASS 2 | 10.5" X 3.0" X 2.0" |
|------------------|---------|---------------------|

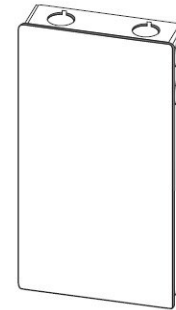

### COMPATIBLE NON-DIMMING DRIVERS

PSHK SERIES  
NON-DIMMING CONSTANT VOLTAGE WITH JUNCTION BOX

|               |         |                        |
|---------------|---------|------------------------|
| PSHK-30W-24V  | CLASS 2 | 6.5" X 3.6" X 1.02"    |
| PSHK-60W-24V  | CLASS 2 | 7.4" X 3.62" X 1.02"   |
| PSHK-96W-24V  | CLASS 2 | 8.66" X 3.66" X 1.61"  |
| PSHK-150W-24V |         | 10.24" X 4.06" X 1.81" |
| PSHK-200W-24V |         | 10.24" X 4.06" X 1.81" |
| PSHK-288W-24V | CLASS 2 | 11.85" X 4.25" X 1.82" |
| PSHK-300W-24V |         | 10.24" X 4.25" X 1.81" |

