

LSP65DX-RGBW

4.6W INDOOR DIGITAL PIXEL COLOR-CHANGING LED STRIP

Project _____
Location _____
Quote/ Ref # _____

LSP65DX-RGBW is an indoor, digital color changing flexible LED strip that provides a full spectrum of color options using red, green and blue LED technology. This addressable RGBW strip can be individually controlled every 4" to create moving effects, patterns, chases and more. The LSP65DX-RGBW is compatible with DMX control systems.

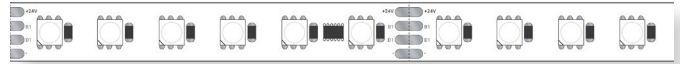

SPECIFICATIONS

INPUT VOLTAGE	24V DC
POWER CONSUMPTION	4.6W/FT
LEDS/ FT.	18 LEDS/Ft.
LEDS PER PIXEL	6 LEDs per pixel - 4 in.
LUMEN OUTPUT	227 Lm/Ft.
DIMMING	Through DMX controller
MAXIMUM RUN LENGTH	16 Ft.
CUTTABLE	Every 3.9" (100 mm)
BEAM ANGLE	120°
IP RATING	Indoor
CERTIFICATIONS	UL Listed
LUMEN MAINTENANCE	50,000 Hrs.

LUMENS

CCT	LM/ FT
RGBW (Digital)	227
RGB	142
3000K	85



MODEL	COLOR TEMP	LENGTH	VOLTAGE	PROFILE
LSP65DX	RGBW30K RGB+3000K	16 16 Ft.	24 24V DC	<i>See Page 2 for compatible profiles.</i>
	RGBW40K RGB+4000K	100 100 Ft.		
	'XX Per Ft.			

*1 = Custom length per FT.

LSP65DX-RGBW

4.6W INDOOR DIGITAL PIXEL COLOR-CHANGING LED STRIP

DIMENSIONS

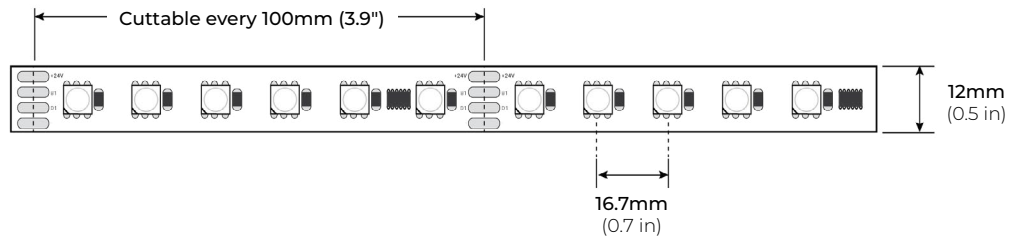

COMPATIBLE ALUMINUM PROFILES

SURFACE PROFILES

ALU-SF

LENGTHS 39" | 78" | 84" | 98"
LENS Clear, Frosted
FINISH Black | Silver

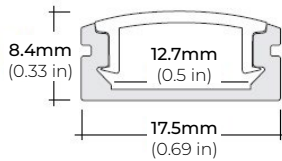

ALU-CN (CORNER)

LENGTHS 39" | 78" | 84" | 96"
LENS Clear, Frosted
FINISH Silver

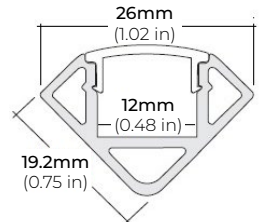

ALU-DS100

LENGTHS 39" | 78" | 84"
LENS Clear, Frosted
FINISH Silver

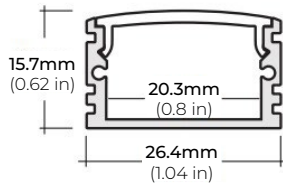

ALP-50C (CORNER)

LENGTHS 48" | 84" | 98"
LENS Frosted
FINISH Black | Silver

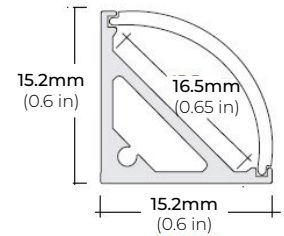

ALP-70

LENGTHS 49" | 84" | 98"
LENS Frosted
FINISH White | Black | Silver

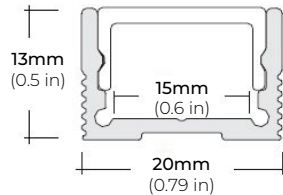

ALP-75C (CORNER)

LENGTHS 49" | 84" | 98"
LENS Frosted
FINISH Black | Silver

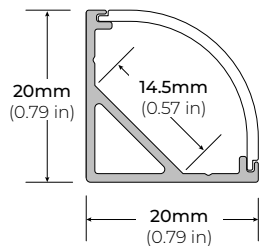

* For more compatible profiles, visit corelightingusa.com

RECESSED PROFILES

ALP-70R

LENGTHS 48" | 98"
LENS Frosted
FINISH White | Black | Silver

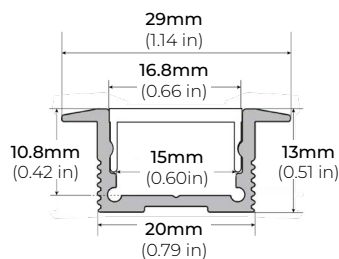

ALP-102R

LENGTHS 49" | 98"
LENS Frosted, Black, Asymmetric, Double Asymmetric
FINISH Silver

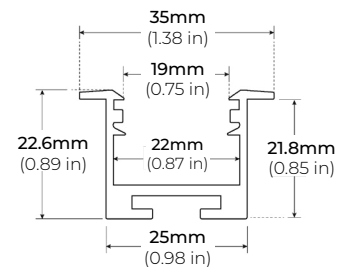

* For more compatible profiles, visit corelightingusa.com

LSP65DX-RGBW

4.6W INDOOR DIGITAL PIXEL COLOR-CHANGING LED STRIP

DMX CONTROLLERS

RGB-SCW4

WiFi DMX WALL CONTROLLER

INPUT VOLTAGE	5 - 10V DC, 06A
OUTPUT SIGNAL	DMX512 (x2)
PROGRAMMABILITY	PC/ MAC
COLOR OPTIONS	Black/ White
CONNECTIONS	USB/ 8dry contact ports/ Open drain output (for relay)
MEMORY	Built-In Flash
WORKING TEMP	-10°C ~ 45°C
DIMENSIONS	LxWxH (5.75"x4.17"x0.43")

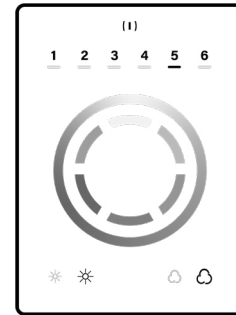

RGB-SDE3

WiFi DMX WALL CONTROLLER

INPUT VOLTAGE	6V DC, 0.6A
OUTPUT SIGNAL	DMX512 (x2)
PROGRAMMABILITY	PC/ MAC/ Tablet/ Smartphone
COLOR OPTIONS	Black/ White
CONNECTIONS	USB/ Ethernet/ RS232/ CLock/ 8dry contact ports/ 5V output relay
MEMORY	MicroSD Card
WORKING TEMP	-20°C ~ 40°C
DIMENSIONS	LxWxH (5.75"x4.17"x0.43")

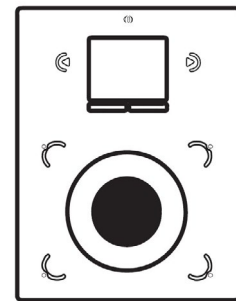

DMX DECODERS

DMX-SPI-XLR

DIGITAL DMX DECODER

INPUT VOLTAGE	5V-24V DC
INPUT SIGNAL	DMX512 + RF 2.4GHZ
OUTPUT SIGNAL	SPI (TTL) x 3
OUTPUT CHANNELS	RGB 510
DIMENSIONS	LxWxH (6.5"x2.8"x1.5")

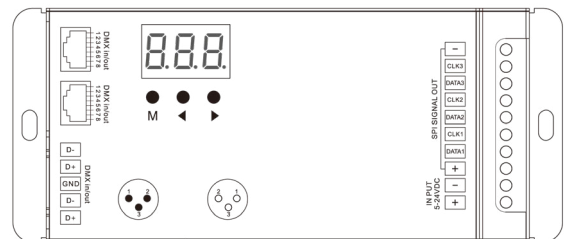

NON-DIMMING DRIVERS (COMPATABLE WITH ALL SYSTEMS)

PSHK SERIES

NON-DIMMING CONSTANT VOLTAGE WITH JUNCTION BOX

PSHK-30W-24V	CLASS 2	6.5" X 3.6" X 1.02"
PSHK-60W-24V	CLASS 2	7.4" X 3.62" X 1.02"
PSHK-96W-24V	CLASS 2	8.66" X 3.66" X 1.61"
PSHK-150W-24V		10.24" X 4.06" X 1.81"
PSHK-200W-24V		10.24" X 4.06" X 1.81"
PSHK-288W-24V	CLASS 2	11.85" X 4.25" X 1.82"
PSHK-300W-24V		10.24" X 4.25" X 1.81"

